

CITY OF ADELAIDE HERITAGE STUDY		ASSESSMENT SUMMARY SHEET 1/1		A1 FORM/BUILDING No. 11/0303-1		CORPORATION USE ONLY						
A2 CURRENT NAME OF ITEM Former Warehouse			A3 ADDRESS/LOCATION OF ITEM 24 Divett Place			A4 P.T.A. 299		A5 ASSESSMENT NO.				
R1 CURRENT OWNER B.J. Gepp, P.G. Long, Strata Plan 5444			B2 PREDOMINANT USE Offices.			A6 NATIONAL MAP GRID CO-ORDINATES			A7 PRECINCT F8 Wakefield St.			
C1 FORMER NAME(S) OF ITEM -		C2 FORMER OWNER(S) Minister of Works W. Menz & Co. Goode Durrant & Co. Charles Henry Goode		C3 FORMER USE(S) Warehouse		A8 DEVELOPMENT ZONE F8.1			A9 FURTHER VIABILITY STUDY REQUIRED			
D1 HISTORICAL THEME(S) Economy - Importing business					G1 INVENTORY GRADING B							
E1 HISTORICAL PERIOD(S) 1885-1913 - Depression and Social Change					H1 LISTING RE- COMMENDED							
F1 VERIFIED DATE(S) 1890 - ACC Assessment Records					Yes							
EVALUATION COMPONENTS								COMMENT				
HISTORY (J1-J3)								GRADING				
								E	VG	G	F/p	NA
J1 PERSON/GROUP		This warehouse was built for Goode Durrant & Co., one of the leading merchant firms in Adelaide.							*			
J2 EVENT											*	
J3 CONTEXT		This is associated with the economic expansion of South Australian enterprise into N.S.W. and W.A. in late 19th Century.							*			
DESIGN (K1-K6)												
K1 DESIGNER		-										
K2 CONTRACTOR		-										
K3 STYLE		A very good example of building type rather than building style which is typically late Victorian.								*		
K4 DESIGN		An important plan-form of warehouse combining the entrance to the court at the rear with the warehouse and what appears to have been a residence.							*			
K5 CONSTRUCTION		Bluestone with red brick and stuccoed dressings.								*		
K6 INTERIOR		Recently refurbished for office use.									*	
INTEGRITY (L1-L2)												
L1 ALTERATIONS		Former accretions to rear have been removed. New door and window openings provided to suit new accommodation requirements.								*		
L2 CONDITION		In good condition as a result of renovation work.								*		
ENVIRONMENT (M1-M2)												
M1 STREETScape/ LANDSCAPE		A distinctive element in Divett Place, and one which contributes to the streetscape.								*		
M2 LANDMARK		Not a dominant element given the narrowness of the street.									*	
N1 OTHER COMMENT		Goode Durrant & Co. was one of Adelaide's leading merchant firms, with branches in London, Broken Hill, Perth and Kalgoorlie. This firm was established in 1882, but that of Goode Brothers began in 1850.										
Amended 16/9/83.												
0 HERITAGE LISTING STATUS	01 NATIONAL TRUST Recorded List	02 NATIONAL ESTATE -	03 STATE HERITAGE -	04 OTHER -	05 LOMHAC LISTING ENDORSEMENT Yes.							



CITY of ADELAIDE HERITAGE STUDY

THE CITY HERITAGE REGISTER — DEFINITION OF ITEMS

ITEM OFFICES (former WAREHOUSE AND STABLES)

BUILDING NO.

11/0303-1

ADDRESS 22-26 Divett Place

CT 4207/638-641 (inc.)

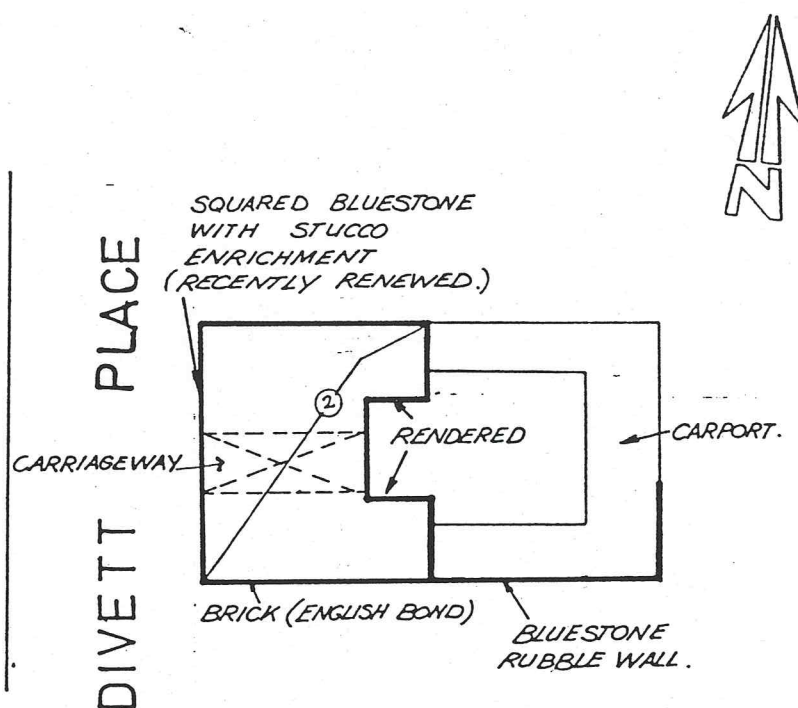

To: South Australian Heritage Committee
From: Senior Historic Architect
Subject: REGISTER NOMINATION REPORT:
GOODE AND DURRANT STABLES, 42-44 DIVETT PLACE, ADELAIDE
Date: 25 February 1982

SUMMARY

This report has been prepared as a result of an enquiry from the Lands Department as to the heritage significance of the Menz Biscuit Factory site. This building is part of that site. The site belongs to the State Government who will be auctioning it off on Thursday, 4/3/82. The site also includes the Biscuit Factory and the Wheelwright Arms Hotel. This nomination has been initiated by the Heritage Conservation Branch.

Historically, the Stables is significant because it represents an essential support industry of late 19th century Adelaide and is associated with two prominent colonial identities, namely Menz & Co. and Sir Charles Henry Goode.

Architecturally, the Stables is a notable example of this scarce building type in the inner city area. Although its decoration is modest, the design is interesting for its strength and clarity.

Environmentally, the Stables is a significant element in the scale of the character of Divett Place and of the area around it.

The Integrity of the Stables is very high despite superficial deterioration of the rendered quoins on the front. While a portion of the Stables roof is missing, its original construction and extent is obvious.

The Goode and Durrant Stables are on the Register of the National Trust as a Recorded Listing.

Recommendations

It is recommended that the Goode and Durrant Stables, 42-44 Divett Place, Adelaide, be placed on the Register of State Heritage Items and be categorized A2, A3.

Mark A. Bussell

pr

Barry G. Rowney

IN:JD

South Australian Heritage Act 1978-80	Register of State Heritage Items ITEM EVALUATION SHEET Buildings and Structures	
	Item GOODE & DURRANT STABLES -22,23 DIVETT PLACE, ADELAIDE (Later Became Part of the Menz Biscuit Factory)	
Age 1880- Unconfirmed	Theme	Office
Period 1852-1883	Subject TRADE & COMMERCE - Retail TRANSPORTATION - Shelter	Region Adelaide City
Building Type Stables/Residence	Style Victorian	Status Adelaide Heritage Survey, N.T. (RL)

Qualitative Data

Component	Comment	Grading				
		E	VG	AG	FP	NA
<u>History</u>						
1. Context:	Associated with early patterns of trade and commerce, the building states the importance of horses in the inner city during the latter half of the C19 and was a vital adjunct to business activity.	*				
2. Person/Group:	Sir Charles Henry Goode, Merchant, MP, JP, Magistrate & Philanthropist, owned the stables and actively participated in the Baptist Church nearby for 32 years. The Menz Co., a neighbouring family business used the stables to house their delivery carts and horses from 1914 until motor transport was used.		*			
3. Event:	1886 owned by Samuel Chiles, Gentleman, of Hyde Park. 1889 bought by C.H. Goode, who in 1898 went into partnership with Mr. Durrant. 1914 leased to Menz & Co. who stabled horses there, subletting the front offices.			*		
<u>Architecture</u>						
4. Architect/ Builder:	Not readily available.					*
5. Design:	Central courtyard with two storey shop/residence at front with drive-through, stabling area brick paved with skillion roofs, front portion has hip roof with Dormer gable over drive-through, unusual curved rendered soffit, simple rendered quoins at front, simple shop front on south end, residence on north.		*			
6. Construction:	Major portion has squared and coursed stone rubble walls with either rendered or projecting brick quoins at corners and openings, minor portion at rear in full brick, corrugated iron hip and skillion roofs.			*		
7. Interior:	Plastered walls, ceilings and decorations in residence, painted stone walls and corrugated iron ceilings in shop, all joinery intact except for fireplace surrounds.			*		

South Australian Heritage Act 1978-80	Register of State Heritage Items ITEM EVALUATION SHEET Buildings and Structures Item GOODE & DURRANT STABLES-22,23 DIVETT PLACE, ADELAIDE													
<table style="width: 100%;"> <tr> <th style="width: 50%;">Component</th> <th style="width: 50%;">Comment</th> </tr> </table>		Component	Comment	<table style="width: 100%;"> <tr> <th colspan="5">Grading</th> </tr> <tr> <th>E</th> <th>VG</th> <th>AG</th> <th>FP</th> <th>NA</th> </tr> </table>	Grading					E	VG	AG	FP	NA
Component	Comment													
Grading														
E	VG	AG	FP	NA										
8. Representation: Scarce example of inner city commercial stable.		<table style="width: 100%;"> <tr> <td style="width: 20%;">*</td> <td style="width: 20%;"></td> <td style="width: 20%;"></td> <td style="width: 20%;"></td> <td style="width: 20%;"></td> </tr> </table>	*											
*														
<u>Environment</u>														
9. Continuity: Establishes and supports the traditional scale and character of Divett Place, adjacent buildings sympathetic in scale and function.		<table style="width: 100%;"> <tr> <td style="width: 20%;"></td> <td style="width: 20%;">*</td> <td style="width: 20%;"></td> <td style="width: 20%;"></td> <td style="width: 20%;"></td> </tr> </table>		*										
	*													
10. Local Character: Supports the character of the city in scale, materials and traditional design, local mutual support given by Menz Biscuit Factory, Wakefield Hotel and Baptist Church.		<table style="width: 100%;"> <tr> <td style="width: 20%;"></td> <td style="width: 20%;">*</td> <td style="width: 20%;"></td> <td style="width: 20%;"></td> <td style="width: 20%;"></td> </tr> </table>		*										
	*													
11. Landmark: Dormer gable roof form against the skyline contrasts adjacent rectilinear buildings.		<table style="width: 100%;"> <tr> <td style="width: 20%;"></td> <td style="width: 20%;"></td> <td style="width: 20%;">*</td> <td style="width: 20%;"></td> <td style="width: 20%;"></td> </tr> </table>			*									
		*												
<u>Integrity</u>														
12. Alterations: Very intact, new opening in courtyard wall, portion of stables roof removed, concreting of some brick paving.		<table style="width: 100%;"> <tr> <td style="width: 20%;"></td> <td style="width: 20%;">*</td> <td style="width: 20%;"></td> <td style="width: 20%;"></td> <td style="width: 20%;"></td> </tr> </table>		*										
	*													
13. Condition: No major structural faults, flaking of render on front, some joints in brickwork need pointing, some external timberwork rotting.		<table style="width: 100%;"> <tr> <td style="width: 20%;"></td> <td style="width: 20%;"></td> <td style="width: 20%;">*</td> <td style="width: 20%;"></td> <td style="width: 20%;"></td> </tr> </table>			*									
		*												
14. Compatability: Residence and shop are vacant, stabling area used for car park.		<table style="width: 100%;"> <tr> <td style="width: 20%;"></td> <td style="width: 20%;"></td> <td style="width: 20%;">*</td> <td style="width: 20%;"></td> <td style="width: 20%;"></td> </tr> </table>			*									
		*												
<u>Supplementary Information</u>														
15. Adaptation: The building could be readily adapted for a commercial and/or residential function. The open nature of the courtyard and stabling area should be maintained but could be enclosed with glass to increase the usable space.														
16. Interpretation: The building's interpretative value is probably passive although public access to the rear portion would lend itself to indirect interpretation of this building type as a disappearing urban item.														
17. Current situation: The building is presently owned by the State Government and is part of the Menz Biscuit Factory site which the Government is considering selling. The Heritage Conservation Branch has been requested to evaluate its Heritage potential prior to any sale. The building is presently vacant.														
Evaluated By Ivar Nelsen Register Architect		Iris Iwanicki Register Historian												
Reviewed By M.A. Butcher Acting Register Supervisor														
South Australian Heritage Committee Categorization		Date												

I.E.S./D3/211081

HISTORICAL RESEARCH: GOODE & DURRANT STABLES, 22-24 DIVETT PLACE, ADELAIDE

The Stables building represents what was a common aspect of trade and commerce in the latter half of the C19 in Adelaide. Located between main thoroughfares, the building provided unobtrusive yet accessible stabling and feed for horses used by Mr. Charles Henry Goode possibly in the course of his merchandising business, after he bought the property in 1889. The earlier owner is described as a Samuel Chiles, Gentleman, of Hyde Park, who bought the property in 1886. Leased in 1914 and later sold to Menz & Co., it was used by the firm to stable delivery horses who transported the firm's biscuits and confectionery as far away as Gawler.

In terms of local significance, the building was associated with Sir Charles Henry Goode who amongst other activities, took the men's Bible Classes at the nearby Baptist Church in Flinders Street for 32 years. He was also a founder of the Y.M.C.A. whose present building faces Divett Place in Flinders Street. A Member for East Torrens in the House of Assembly from 1865-1866, he then directed the business in London for 12 years after the cotton industry collapsed as a result of the American Civil War. When he returned to Adelaide, he formed a partnership with W.H. Durrant, his London Manager and W.H. Tite, an Adelaide Business Associate. He became the President of the Royal Institute for the Blind until 1922, Founder of the Adult Deaf and Dumb Mission and the Adelaide Children's Hospital. His philanthropic activities resulted in a Knighthood in 1919 and the following tribute appeared in "The Mail":

"His name was a synonym for a charitable works. Despite all the wonderful work done in this respect his efforts stand right out and every member of the community is proud to acknowledge the excellence of this Prince of Philanthropists."¹

The stables relative historic significance lies in its exemplifying the early stabling arrangements in Adelaide during the latter part of the C19. A link to the nearby Methodist Church and Y.M.C.A. building is provided by its owner Sir Charles Henry Goode, whose name appears on the Certificate of Title, is changed to Goode Durrant & Co. Ltd. in 1898, and later to Goode Durrant & Murray Ltd. This link is borne out visually in the similarity of the building materials used in the construction of the stables and the wall and building of the Church. It also contributes to the expansion of the nearby Menz Biscuit Factory, a family business established in 1850.

Sources: Douglas Pike: Australian Dictionary 1851-1890.
F. Johns: Notable Australians: Robertson & Co. P/L p. 1977-78.
G.F. Loyau: Notable South Australians, 1885, p.35.

I. Iwanicki
REGISTER HISTORIAN

II:SK
24/2/1982

1. Pike, Australian Dictionary of Biography, p. 262-3.



FILM NO.
419

GOODFELLOW DURRANT STABLES -
ADELAIDE

FEB 82



FILM NO.
417

GOODE AND DURRANT STABLES -
DIUETT PLACE

JAN 82