

South Australian Heritage Act 1978-80	MOUNT BARKER DISTRICT HERITAGE SURVEY (STAGE ONE) ITEM IDENTIFICATION SHEET	PROJECT DATE C1860's Item Ref. No. 218
	ITEM NAME: POWDER MAGAZINE Former or other	Office Use ITEM No. DOCKET No.
HERITAGE SIGNIFICANCE A domed hut at Callington, just off Murray Bridge Road. Owned by Worthing Mining Co to store explosives. Small, circular, window-less. C 1860. Would not have been built before this date, as the settling tanks right along would have provided a danger which it is thought Alfred Hallett, the widely-respected mine captain, would not have allowed. (Settling tanks closed 1860-61). (See Mt. Barker District Diagram 2 for location).		LOCATION Address Town Callington Postcode Section 2001 Hundred Kanmantoo, Monarto County L.G.A. C.T. Vol 420 S.H.P. Region Pol.922 A.M.G. Ref. 6627-10499 SUBJECT Economic History PERIOD 1852-1883 State Study Area
REFERENCES Registered State Heritage 6627-10499. Austin's "Mines of S.A.", 1863. Owner: International Sheep and Cattle Suppliers, 212 Glen Osmond Road, Fullarton 5063. Verbal Archival photographs		TYPE OF ITEM LAND Natural feature <input type="checkbox"/> Historical site <input type="checkbox"/> Historical Gdn. <input type="checkbox"/> BUILDING <input checked="" type="checkbox"/> STRUCTURE <input type="checkbox"/> PHYSICAL CONDITION
PHOTOGRAPH Film No. Negative No. Direction of view 		STATUS Reg. of State Her. Items Reg. <input checked="" type="checkbox"/> Interim L <input type="checkbox"/> Nominated <input type="checkbox"/> National Estate Reg. <input checked="" type="checkbox"/> Proposed L <input type="checkbox"/> National Trust CL <input checked="" type="checkbox"/> RL <input type="checkbox"/> File <input type="checkbox"/> Other RECOMMENDATION (A) State <input checked="" type="checkbox"/> (B) Local <input type="checkbox"/> PREPARED BY Date:

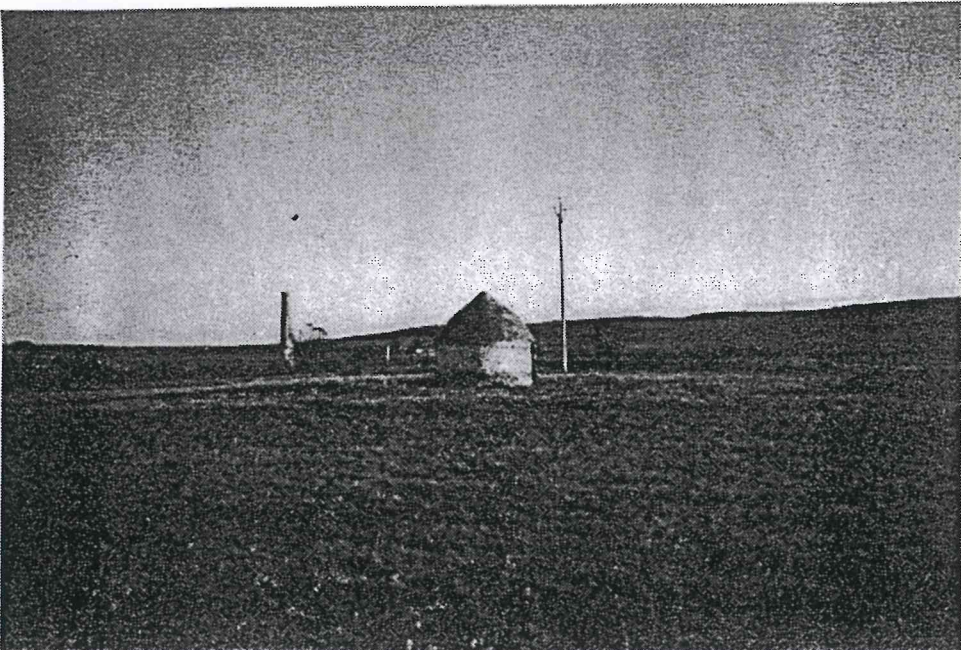
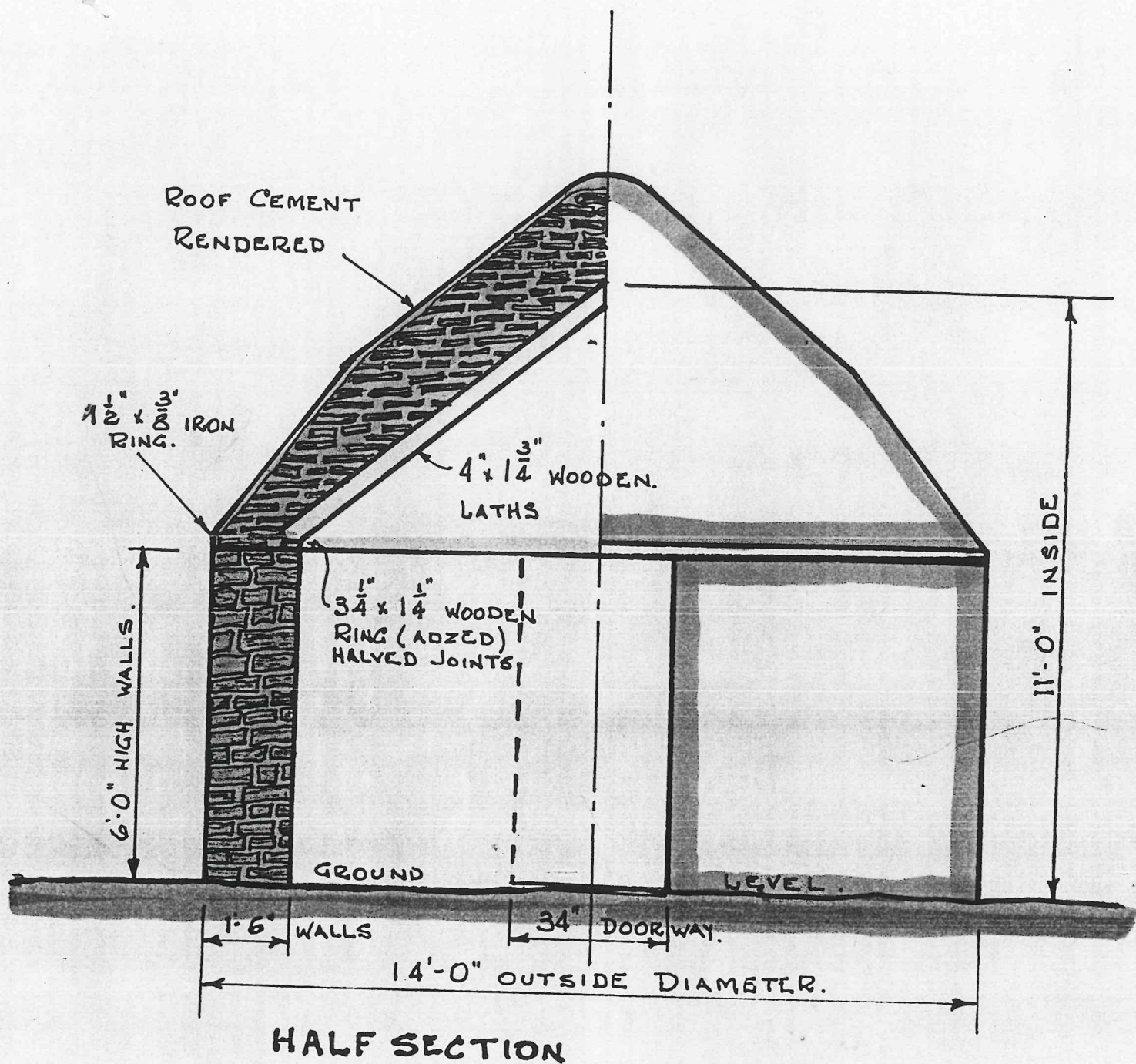

EXPLOSIVES MAGAZINE

BREMER MINE

CALLINGTON SOUTH AUST.

MATERIAL STONE.

CONDITION NOV. 1982 STONEMWORK - VERY GOOD

WOOD IN CEILING - VERY GOOD. DOORS FRAME MISSING.

J.E. CONNELL
10.11.82.

SCALE $\frac{3}{8}$ " = 1 FOOT (1:32).

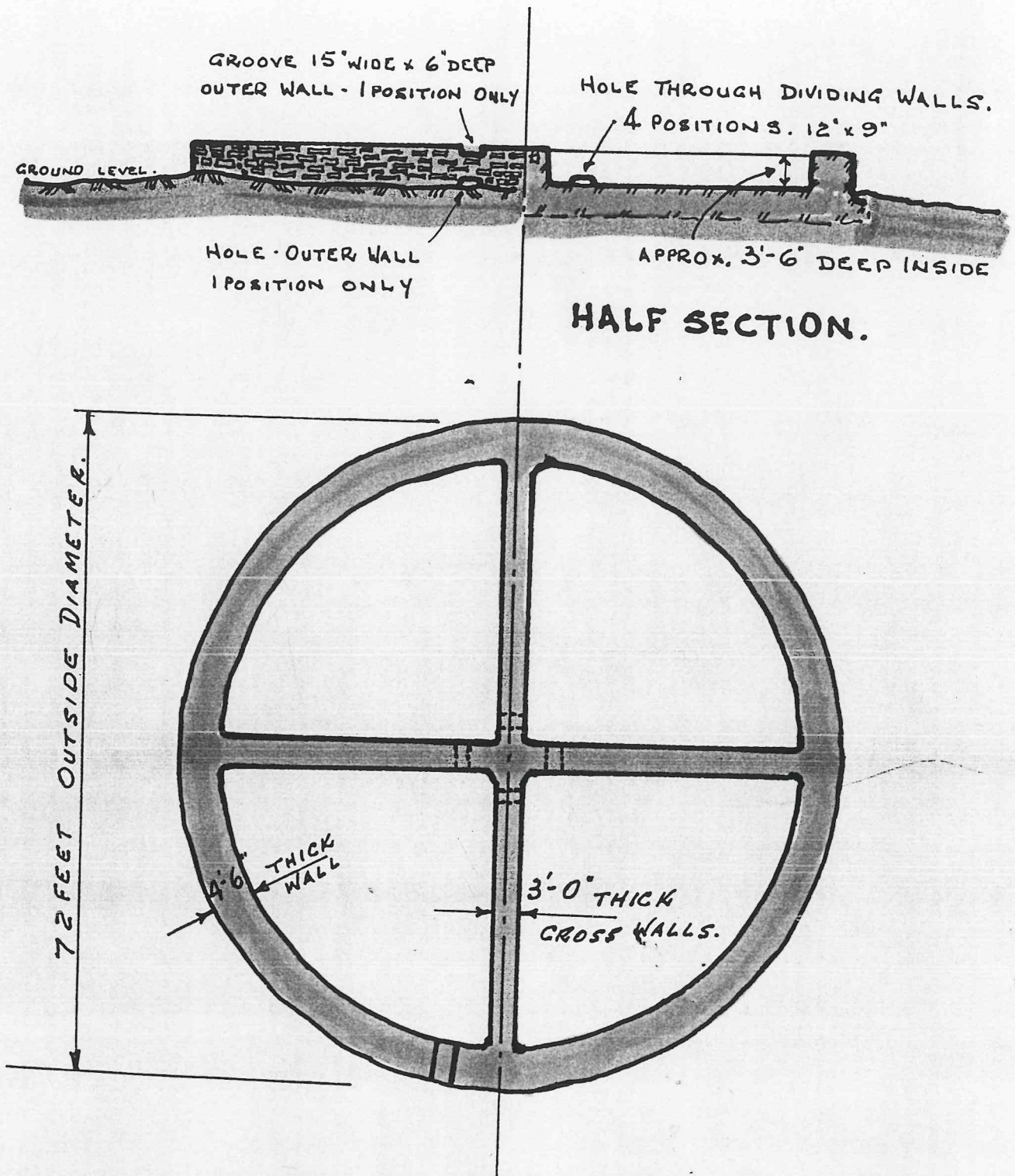

SETTLING TANK

BREMER MINE CALLINGTON STH. AUST.

MATERIAL OF CONSTRUCTION.

INNER LINING

OUTER SURFACE

FLOOR

SCHIST.

CEMENT RENDERED.

UNDRESSED SCHIST.

COVERED WITH DEBRIS.

CONDITION. NOV 1982. ALMOST INTACT. FEW TOP STONES
DISPLACED- SOME INNER LINING SPALLED OFF.-
SURFACE OF EXTERNAL WALLS WIND ERODED

J.E. CONNELL.
10.11.82.

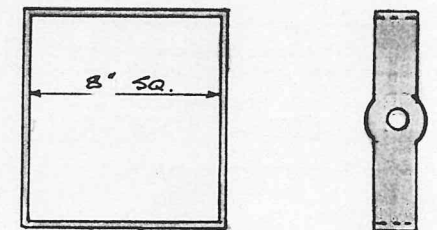
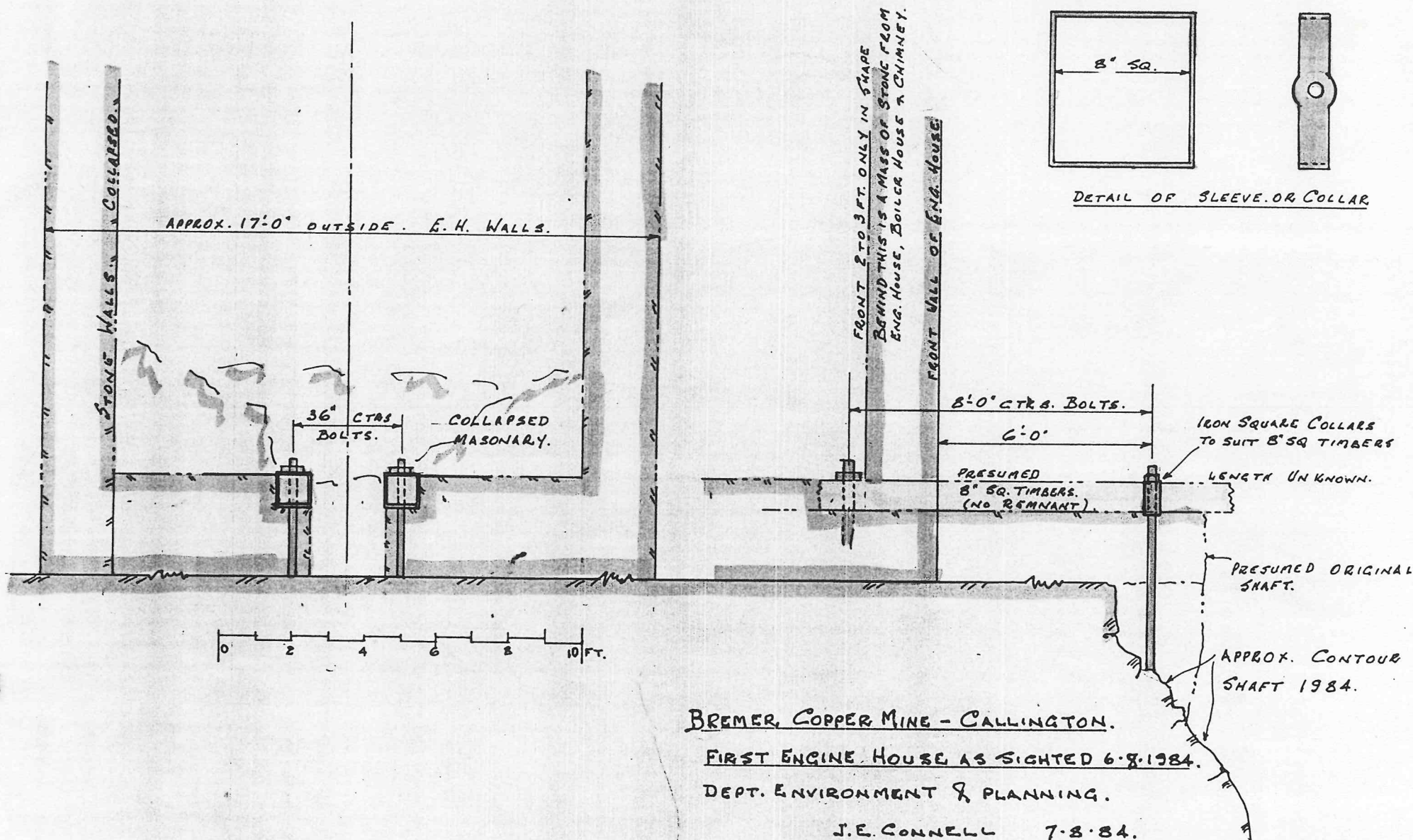

DETAIL OF SLEEVE OR COLLAR

BREMER, COPPER MINE - CALLINGTON.

FIRST ENGINE HOUSE AS SIGHTED 6.8.1984.

DEPT. ENVIRONMENT & PLANNING.

J.E. CONNELL 7.8.84.

Bremer

1848
Copper mineralisation was found by the Paringa Mining Co. near Bremer River in 1948, but lack of capital prevented installation of dewatering equipment, and mining was restricted to shallow depths.

In 1856, Bremer Mine was sold to the Worthing Mining Co., and a dewatering engine installed. Twenty thousand tonnes of copper ore were raised to 1870, when falling copper prices forced the company into liquidation.

* Bremer Mining Co. worked the leases from 1872 to 1875 for a further ten thousand tonnes of ore.

56 Worthing Mining Co. operations at Bremer Mine in the late 1860s. A Cornish pumping engine was housed in the tall building at left; the building in the background housed another engine for raising ore and providing power to dressing machinery. The ore sorting shed in the left foreground partly obscures a horse whim.

