

MASONIC TEMPLE  
254 North Terrace

This building is historically significant because of its association with, and the fact that it epitomises, the role and development of Freemasonry in South Australia. Indeed, the South Australian Grand Lodge was the first to be established in Australia. The South Australia Lodge was established before the Colony was founded - and its membership has included numerous men who have had a great impact on South Australia's history.

The architects for the project were "Brothers" J. Quinton Bruce and W.H. Harral, who had submitted a design in 1923 which had been unanimously accepted. However, when tenders were first called, the cost was far in excess of that which had been envisaged. "From the specifications therefore were eliminated the cut stone and granite work ... the first tenders were so prohibitive that the building committee had no alternative but to arrange for a reinforced concrete structure. This was a disappointment to many craftsmen to whom the aesthetic appeals, but Freemasons do not believe in over-running the constable even for the sake of appearances ... the front facade of the building will be 130' long rising above the footpath to a height of 100'. The front portion of the edifice will comprise five storeys and a basement. The rear portion will have the Great Hall for Grand Lodge functions and be available for letting purposes ... On the ground floor will be the administrative offices and billiard rooms and the Hall of Fame, this last rising two storeys with a balcony all round at the height of the first floor level." W.H. Harral personally superintended the work, the main contract for which was let to Messrs. Anderson and Company. The building was opened in May, 1927. (For dedication details see The South Australian Freemason 10th May, 1927).

This City landmark is notable as it perhaps best exemplifies the way in which compromises were reached between the expression of form and expression of function in buildings during this transitional period. The choice of classical orders and stylised ornament of Roman origin was a deliberate one since the Orders figure prominently as part of Masonic ritual. The central Hall of Fame is most notable for its propylaeum-like form aptly chosen for this building. The interior is of note for its lofty halls and spaces as well as its impressively executed detailing. Environmentally, this building is significant because of its landmark quality on North Terrace. Because of its size, scale and form, it dominates its surroundings, though is complemented by the scale and massing of the Brookman building on the northern side of North Terrace.

The integrity of the building is high with few alterations being in evidence to the street facade or public interior spaces.

D.M.S.  
(Amended 21/9/83)  
5:DCP10C/I

<b>CITY OF ADELAIDE HERITAGE STUDY</b>		<b>ASSESSMENT SUMMARY SHEET 1/1</b>		<b>A1 FORM/BUILDING No. 4/0104</b>		<b>CORPORATION USE ONLY</b>					
<b>A2 CURRENT NAME OF ITEM</b> MASONIC TEMPLE		<b>A3 ADDRESS/LOCATION OF ITEM</b> 254 North Terrace			<b>A4 P.T.A.</b> 26		<b>A5 ASSESSMENT NO.</b>				
<b>B1 CURRENT OWNER</b> H Wilckens, JA Davis WB Allan, JHR Garde,		<b>B2 PREDOMINANT USE</b> Meetings/Offices				<b>A6 NATIONAL MAP GRID CO-ORDINATES</b>					
<b>C1 FORMER NAME(S) OF ITEM</b> -		<b>C2 FORMER OWNER(S)</b> -		<b>C3 FORMER USE(S)</b> -			<b>A7 PRECINCT</b> F14 North Terrace Precinct				
<b>D1 HISTORICAL THEME(S)</b> Social Life					<b>G1 INVENTORY GRADING</b>  A  <b>H1 LISTING RE- COMMENDED</b> Yes		<b>A8 DEVELOPMENT ZONE</b> F14.2				
<b>E1 HISTORICAL PERIOD(S)</b> 1924-1927 - War and Change.							<b>A9 FURTHER VIABILITY STUDY REQUIRED</b>				
<b>F1 VERIFIED DATE(S)</b> 1925-1927 (Opened May 1927)											
<b>EVALUATION COMPONENTS</b>						<b>COMMENT</b>					
<b>HISTORY (J1-J3)</b>						<b>GRADING</b>					
						E VG G F/p NA					
<b>J1 PERSON/GROUP</b>		Freemasons Lodge - headquarters in South Australia.						*			
<b>J2 EVENT</b>										*	
<b>J3 CONTEXT</b>		This epitomises the development of freemasonry in South Australia - and the influence of the fraternity.						*			
<b>DESIGN (K1-K6)</b>											
<b>K1 DESIGNER</b>		Bruce and Harral.						*			
<b>K2 CONTRACTOR</b>		Anderson & Company								*	
<b>K3 STYLE</b>		Stylised classicism - a building of the transitional period.						*			
<b>K4 DESIGN</b>		The form of the building & its detailing both in cement and metal work typify this period of building activity.						*			
<b>K5 CONSTRUCTION</b>		Of reinforced concrete.						*			
<b>K6 INTERIOR</b>		Largely original and of great importance, particularly the Hall of Fame.						*			
<b>INTEGRITY (L1-L2)</b>											
<b>L1 ALTERATIONS</b>		None readily apparent excepting balcony enclosure. At present, being renovated (1983).						*			
<b>L2 CONDITION</b>		Building appears to be in very good condition - structurally sound.						*			
<b>ENVIRONMENT (M1-M2)</b>											
<b>M1 STREETScape/LANDSCAPE</b>		A dominant building.						*			
<b>M2 LANDMARK</b>		A very dominant building on North Terrace.						*			
<b>N1 OTHER COMMENT</b>											
Built at a time when reinforced concrete was still something of an innovation, and commented upon as such.											
Amended 20/9/83											
<b>O HERITAGE LISTING STATUS</b>	<b>O1 NATIONAL TRUST</b>	<b>O2 NATIONAL ESTATE</b>	<b>O3 STATE HERITAGE</b>	<b>O4 OTHER</b>	<b>O5 LOMHAC LISTING ENDORSEMENT</b>						
	-	-	-	-	Yes.						



# CITY of ADELAIDE HERITAGE STUDY

## THE CITY HERITAGE REGISTER — DEFINITION OF ITEMS

ITEM FREEMASONS' HALL

BUILDING NO.  
4/0104

ADDRESS 254-260 North Terrace

CT 2042/61

NORTH

TERRACE

NOTE USE OF METAL TO PORTICO.  
BALCONY APPEARS TO HAVE BEEN ENCLOSED

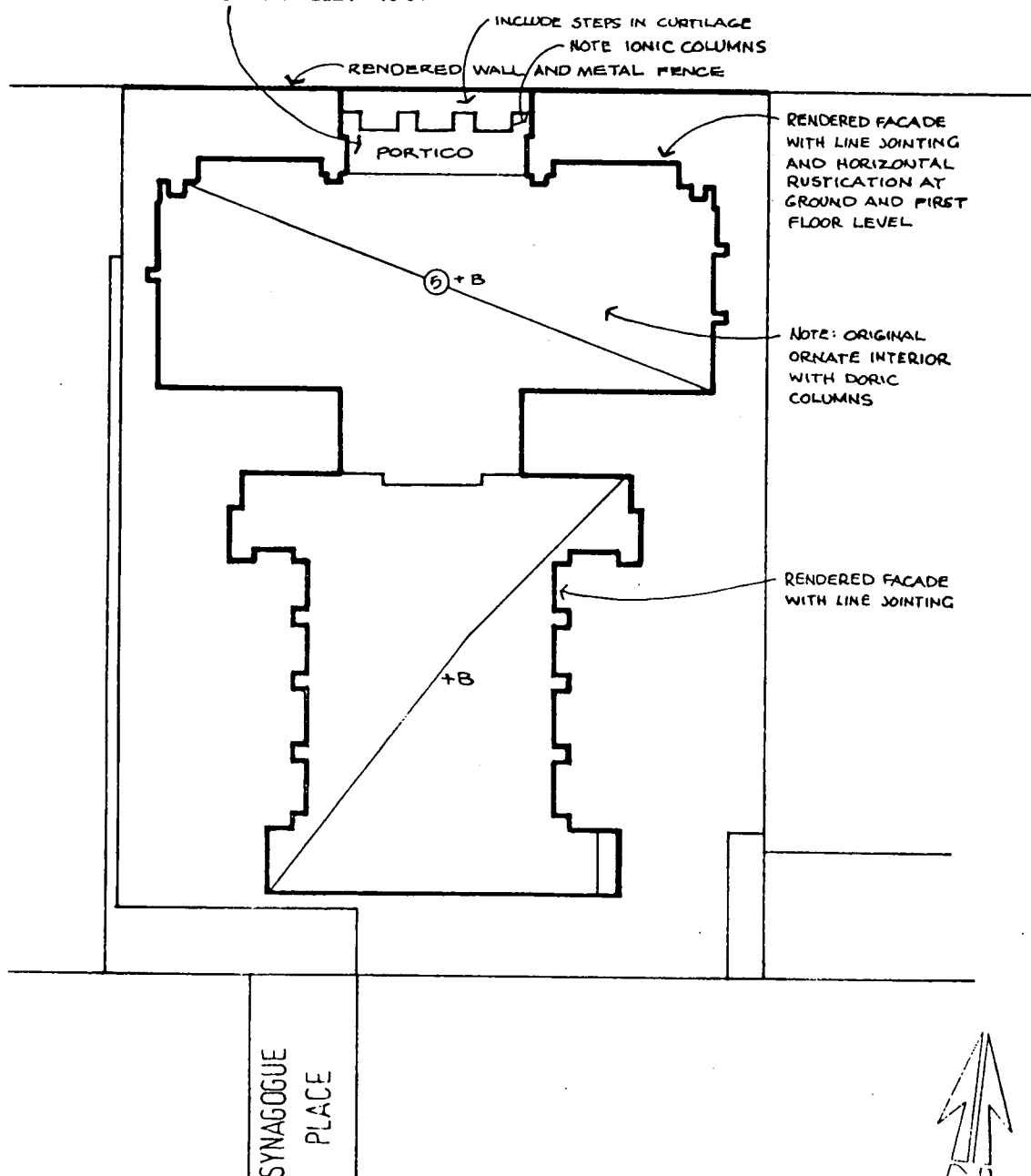

SCALE (approx) 1 : 480

## SOUTH AUSTRALIAN HERITAGE ACT, 1978

*Entry of Items on the Register of State Heritage Items*

There has been an increased community awareness of the need to protect those buildings and features of our State which reflect our cultural heritage. The South Australian Government has recognised that awareness by passing the South Australian Heritage Act, 1978, for which the Minister for Environment and Planning is responsible. In accordance with the provisions of the Act, the Register of State Heritage Items is being compiled.

Where the Minister considers that an item (defined as any land, building or structure) that is not on the Register is part of the physical, social or cultural heritage of the State and that the item is of significant aesthetic, architectural, historical or cultural interest, then the Minister may enter that item on the Register.

Pursuant to the provisions of the South Australian Heritage Act, 1978, I, Don Hopgood, Minister for Environment and Planning and Minister for the time being administering the said Act, hereby give notice that I have entered on the Register of State Heritage Items and the items described in The Schedule hereunder.

Items listed in The Schedule were previously placed on an Interim List in accordance with the provisions of Section 15 of the South Australian Heritage Act, 1978. Excepting items owned by the Crown and those within the area of the corporation of the city of Adelaide, the remaining items listed in The Schedule are subject to Part V of the Planning Act, 1982. That Act requires that no development, including demolition, conversion, alteration of, or addition to any item, is permitted without the written consent of the relevant Planning Authority. Items within the area of the corporation of the city of Adelaide are subject to the provisions of the City of Adelaide Development Control Act, 1976.

## 11TH LISTING OF THE REGISTER

<i>Name</i>	<i>Address</i>
<b>Corporation of the City of Adelaide</b>	
Adelaide Gaol .....	Adelaide 5000. Gaol Reserve, section 549, hundred of Adelaide.
John's Emporium .....	Corner Leigh and Hindley Streets, Adelaide 5000. PTA 76 comprised in LG registered in G.R.O. No. 239, book 1, hundred of Adelaide.
Commonwealth Bank .....	23 Currie Street, Adelaide 5000. CT. volume 1950, folio 183, PTA 139, hundred of Adelaide.
Elder House .....	27 Currie Street, Adelaide 5000. CT. volume 1686, folio 79, PTA 139, hundred of Adelaide.
Stables—Warehouse .....	22-26 Divett Place, Adelaide 5000. CT's. volume 4207, folios 638-641 inclusive, allotment 4 of PTA 299, hundred of Adelaide.
Adelaide Electric Supply Co. Converter Station—Former .....	East Terrace, Adelaide 5000. CT. volume 2161, folio 97, PTA 155, CT. volume 1833, folio 71, PTA 154, hundred of Adelaide.
Stock Exchange .....	55 Exchange Place, Adelaide 5000. CT. volume 732, folio 5, PTA 169, hundred of Adelaide.
Bertram House .....	73 Grenfell Street, Adelaide 5000. CT. volume 3142, folio 108, PTA 144, hundred of Adelaide.
Grenfell Street Mail Exchange—Former .....	101-107 Grenfell Street, Adelaide 5000. CT. volume 2148, folio 153, PTA 146, hundred of Adelaide.
Adelaide Electric Supply Co. Power Station—Former .....	243 Grenfell Street, Adelaide 5000. CT. volume 2161, folio 96, PTA 155, hundred of Adelaide.
YWCA Headquarters—Former .....	49 Hindmarsh Square, Adelaide 5000. CT. volume 4185, folio 893, PTA 147, hundred of Adelaide.
Cathedral Hotel .....	47 Kermode Street, North Adelaide 5006. CT. volume 3122, folio 49, PTA 714, hundred of Adelaide.
Bank of Adelaide—Former .....	81 King William Street, Adelaide 5000. CT. volume 1938, folio 191, PTA 140, hundred of Adelaide.
T & G Building .....	82 King William Street, Adelaide 5000. CT. volume 4038, folio 233, PTA 141, hundred of Adelaide.
National Mutual Building—Former .....	91 King William Street, Adelaide 5000. CT. volume 1938, folio 190, PTA 140, hundred of Adelaide.
Dwelling—'Nurney House' .....	Kingston Terrace, North Adelaide 5006. CT. volume 1568, folio 151. PTA's 1027 and 1028, hundred of Adelaide.
<b>Freemason's Hall</b> .....	<b>254 North Terrace, Adelaide 5000. CT. volume 2042, folio 61, PTA 26, hundred of Adelaide.</b>
Aquinas College .....	1 Palmer Place, North Adelaide 5006. CT. volume 167, folio 211, TA 748; CT. volume 727, folio 106, PTA 746; CT. volume 1526, folio 113, TA 747, hundred of Adelaide.
<b>District Council of Burra Burra</b>	
Royal Exchange Hotel .....	Bests Place, Burra 5417. CT. volume 4109, folio 784, part allotment 23 of part section 4, hundred of Koorunga.
Dwellings—Barker of Baldina Homes .....	Chapel Street, Burra 5417. Limited CT. volume B, folio 152, part section 1, hundred of Koorunga.
Dwellings—McBride Cottages .....	Corner Chapel and Bath Streets, Burra 5417. CT. volume 825, folio 140, part allotment J of portions of section 1, hundred of Koorunga.
Koorunga Hotel .....	Corner Kingston Street and Welsh Place, Burra 5417. CT. volume 4214, folio 428, allotment 301 of part section 1, hundred of Koorunga.
Bible Christian Chapel—Former .....	Corner Kingston and Bridge Streets, Burra 5417. CT. volume 2697, folio 64, part allotment 533 of part section 1, hundred of Koorunga.
National Bank .....	Corner Market Street and Mount Pleasant Road, Burra 5417. CT. volume 668, folio 52, part allotment 81 of part section 1, hundred of Koorunga.
Bon Accord Mine Historic Site .....	Corner Railway Terrace and West Street, Burra 5417. CT. volume 3745, folio 8, part allotment 12 of part section 4, hundred of Koorunga.
Stone Wall .....	Commercial Street, Burra 5417. CT. volume 1731, folio 121, part allotments 41 and 49 of portion of section 1, hundred of Koorunga.
Stone Wall .....	Commercial Street, Burra 5417. CT. volume 1363, folio 134, part allotment 75 and allotment 76, hundred of Koorunga.
Commercial Hotel .....	Commercial Street, Burra 5417. CT. volume 3903, folio 100, part allotment 26 of section 1, hundred of Koorunga.

<i>Name</i>	<i>Address</i>
Dwelling and Coach House .....	2 Kangaroo Street, Burra 5417. CT's volume 1731, folio 122 and volume 731, folio 121, part allotment 41 of part section 1; part allotment 49 of part section 1, hundred of Koorunga.
Salvation Army Citadel—Former .....	Kingston Street, Burra 5417. CT. volume 2198, folio 98, allotment 386 of part section 1, hundred of Koorunga.
Burra Hotel .....	Market Square, Burra 5417. CT. volume 4211, folio 961, allotment 3 of part section 1, hundred of Koorunga.
Church—Church of England—St Mary's—Hall ...	Market Street, Burra 5417. Limited CT. volume E, folio 74, part section 1 and part block 14, hundred of Koorunga.
Town Hall .....	Market Street, Burra 5417. CT. volume 2411, folio 192, part allotment 83 of part section 1, hundred of Koorunga.
Smelters Home Hotel—Former .....	Market Street, Burra 5417. CT. volume 2268, folio 144, allotment 3 of part section 1, hundred of Koorunga.
Dwelling—Doctor's Residence .....	3 Market Street, Burra 5417. CT. volume 2003 folio 159. Part allotment 82 of section 1, hundred of Koorunga.
Burra Mines Historic Site .....	Off Market Street, Burra 5417. CT's volume 1687 folio 160, volume 1694 folio 109, volume 1798 folio 19, volume 3761 folio 115 and volume 4108 folio 991, portion of section 1; allotments A and portions of allotment B of portions of section 1 and allotment 1 of block 1 and portions of allotment 430; portion of section 1 and part block 14; allotment 2 of part section 1, hundred of Koorunga.
Burra Smelts Historic Site .....	Off Smelts Road, Burra 5417. CT's volume 997 folio 9, volume 1798 folio 19, volume 1228 folios 24, 25 and 26 and volume 1258 folio 125. Block 11s of section 1; allotments A and portions of allotment B of portions of section 1 and allotment 1 of block 1 and portions of allotment 430; part section 1, hundred of Koorunga.
Cemetery .....	Off Spring Street, Burra 5417. CT's volume 2328 folio 127 and volume 2386 folio 192. Cemetery and reserve of part section 1; part section 1 and part allotment 204 of part section 1, hundred of Koorunga.
Wall and Former Brewery Cellars .....	Paxton Terrace and Tomkinson Street, Burra 5417. CT's volume 4065 folio 458 and volume 4113 folio 47, part section 1; allotment 2 of portion of section 1, hundred of Koorunga.
Railway Station .....	Railway Terrace, Burra 5417, part section 4, hundred of Koorunga.
Former Smelts Managers Residence and Stone Wall .....	9 St Just Street, Burra 5417. CT. volume 1455 folio 48, part allotment 25 in L.T.R.O. plan 3554, hundred of Koorunga.
Masonic Hall—Former Methodist Church .....	Upper Thames Street, Burra 5417. CT. volume 2602 folio 183, part allotment 84 of section 1, hundred of Koorunga.
Dwelling—'Heathmont' .....	Vineyard Terrace, Burra 5417. CT. volume 2276 folio 184, part section 1, hundred of Koorunga.
<b>Corporation of the City of Campbelltown</b>	
Dwelling—'Lochend' .....	Brentyn Court, Campbelltown 5074. LG. volume 4218 folio 403, section 744, hundred of Adelaide.
<b>Corporation of the Town of Gawler</b>	
Ice Works and Office .....	Calton Road, Gawler 5118. CT's volume 2117 folio 31, volume 2117 folio 32, volume 2429 folio 157, volume 3287 folio 73, volume 3287 folio 74 and volume 3512 folio 48, allotment 231 of section 4; part allotment 232 and 233 of section 4; allotment 230 of part section 4; allotments 226-228 inclusive of section 4; allotment 229 of section 4; part allotments 232 and 233 of section 4, hundred of Nuriootpa.
Kingsford Hotel .....	30-32 Murray Street, Gawler 5118. CT. volume 3420 folio 70, part allotments 11, 12 and 13 of section 24, hundred of Mudla Wirra.
Telegraph Station .....	59 Murray Street, Gawler 5118, allotment 195. National Trust Reserve. <i>Government Gazette</i> 19.1.67, hundred of Nuriootpa.
Primary School .....	Nixon Terrace, Gawler 5118. CT. volume 4170 folio 81, allotment 2 of part section 24, hundred of Mulda Wirra.
Wheat Store—Former .....	Twenty Third Street, Gawler 5118. CT's volume 151 folio 71 and volume 1575 folio 193, allotment 11 of section 8, hundred of Munno Para; allotment 12 of section 3246 and part section 8, hundreds of Munno Para and Mudla Wirra.
<b>Corporation of the City of Happy Valley</b>	
Dwelling—'The Braes' .....	Braes Close, Reynella 5161. CT. volume 4176 folio 472, allotment 2 of part section 511, hundred of Noarlunga.
Dwelling .....	Luke Street, Clarendon 5157. CT. volume 4102 folio 427, allotment 1 of part section 801, hundred of Noarlunga.
Hall—Former Bible Christian Church .....	Main Road, Clarendon 5157. CT. volume 1114 folio 107, allotment 622 in F.P. No. 5463, hundred of Noarlunga.
Happy Valley Reservoir—Dam Walls and Towers	Off Chandlers Hill Road, Happy Valley 5159, Happy Valley Reservoir, hundred of Noarlunga.
Farm Building .....	Off Hicks Hill Road, Cherry Gardens via Blackwood 5051. CT. volume 3662 folio 124, part sections 782 and 1080, hundred of Noarlunga.
Clarendon Weir .....	Onkaparinga River, Clarendon 5157. CT. volume 574 folio 2, allotment 32 in F.P. No. 5967, hundreds of Kuitpo and Noarlunga.
Dwelling and Slab Hut .....	Scenic Road, near Clarendon 5157. CT's volume 4161 folio 166 and volume 4161 folio 167, part section 757; section 756 and portions of section 757, hundred of Kuitpo.
<b>District Council of Kanyaka/Quorn</b>	
Shops—Quorn Pottery .....	Railway Terrace, Quorn 5433. CT. volume 4199 folio 184, portion of part allotment 17, hundred of Pichi Richi.
National Bank .....	Railway Terrace, Quorn 5433. CT. volume 1412 folio 172, section 11 and part section 70, hundred of Pichi Richi.
Austral Hotel .....	Railway Terrace, Quorn 5433. CT. volume 3339 folio 18, portion of allotment 16, hundred of Pichi Richi.



<i>Name</i>	<i>Address</i>
<b>District Council of Kapunda</b>	
Dwelling—Miner's Cottage .....	Cameron Street, Kapunda 5373. CT. volume 4068 folio 17, allotment 14 of part section 1271, hundred of Kapunda.
Dwelling—Mine Manager's Cottage .....	Jackson Street, Kapunda 5373. CT. volume 2067 folio 193, part block 22 of part section 1271, hundred of Kapunda.
Miner's Store .....	Mine Street, Kapunda 5373. CT. volume 4101 folio 234, allotment 5 of part section 1271, hundred of Kapunda.
<b>Corporation of the City of Kensington and Norwood</b>	
Dwelling .....	1 William Street, Norwood 5067. CT. volume 4173 folio 232, allotment 12 of part section 261, hundred of Adelaide.
<b>District Council of Kingscote</b>	
Rocky River Homestead .....	Flinders Chase National Park, Kangaroo Island, hundred of McDonald.
<b>District Council of Mount Barker</b>	
Prospect Hill Museum and Outbuildings .....	Prospect Hill via Meadows 5201. CT. volume 1865 folio 76, section 634 and part sections 51 and 3441, hundred of Kuitpo.
<b>District Council of Mount Remarkable</b>	
Copper Mine Chimney (Charlton Run) .....	Via Wirrabara 5481. CT. volume 1464 folio 114, allotment F of section 3524, hundred of Appila.
<b>Corporation of the City of Noarlunga</b>	
Dwelling—Morphett Vale .....	1 Church Street, Morphett Vale 5162. CT. volume 2742 folio 28, part allotment 1 of part section 625, hundred of Noarlunga.
Prospect Farm—Former .....	Sauerbiers Road, Port Noarlunga South 5167. CT. volume 3703 folio 43, part section 333, hundred of Willunga.
<b>District Council of Penola</b>	
Dwelling—'Ulva Cottage' .....	Bowden Street, Penola 5277. CT. volume 1739 folio 183, allotment 49 of portion of section 3, hundred of Penola.
National Bank .....	Corner Church and Riddock Streets, Penola 5277. CT. volume 2604 folio 186, portion of allotment 1 of portion of section 3, hundred of Penola.
Sharam's (First Cottage)—Former Dwelling .....	Wilson's Street, Penola 5277. CT. volume 3520 folio 101, part allotment 136 in G.R.O plan 79 of 1861, hundred of Penola.
<b>Corporation of the City of Port Pirie</b>	
Waterside Worker's Federation Building .....	52-54 Florence Street, Port Pirie 5540. CT. volume 4087 folio 774, portion of part allotments 96 and 120, hundred of Pirie.
<b>District Council of Robe</b>	
Cemetery—Robe .....	Burr Street, Robe 5276. L.G. volume 45 folio 10, part section 127, hundred of Waterhouse.
Dwelling—'Granny Banks' .....	Corner Sturt and Morphett Street, Robe 5276. CT. volume 1935 folio 105, section 79, hundred of Waterhouse.
Dingley Dell .....	Robe 5276. CT. volume 2986 folio 84, part section 400, hundred of Waterhouse.
Royal Circus and Sea Wall Historic Site .....	Robe 5276. Council Reserve. <i>Government Gazette</i> 7.11.1959; sections 526-528 inclusive, hundred of Waterhouse. 4418000526.
Dwelling—'Attic House' .....	Victoria Street, Robe 5276. CT. volume 4040 folio 880, part allotments 8 and 9 of section 218, hundred of Waterhouse.
Wilson's Saddlery—Former .....	Victoria Street, Robe 5276. CT. volume 2361 folio 34, allotment 3 and part allotment 2 of part sections 220 and 221, hundred of Waterhouse.
<b>District Council of Saddleworth and Auburn</b>	
Forester's Hall .....	Main North Road, Watervale 5452. CT. volume 137 folio 200, part allotment 8 of section 146, hundred of Upper Wakefield.
<b>District Council of Tanunda</b>	
Dwelling—'Keil House' .....	Main Road, Bethany via Tanunda 5352. CT. volume 3653 folio 147, part section 4, hundred of Moolooloo.
<b>Unincorporated</b>	
Curdimurka Railway Station Complex .....	Curdimurka Siding via Port Augusta 5710. CT. volume 4210 folio 566, sections 554 to 587, portion of section 588, sections 589 to 621 and allotment 2 of section 622, out of hundreds.
Killalpaninna Mission Historic Site .....	Killalpaninna via Marree 5733. CL. volume 1340 folio 29, block 751, out of hundreds (Kopperamanna).
Mount Victoria Well and Whim Historic Site .....	Pumbago Station via Olary 5440. Out of hundreds.
<b>Corporation of the City of West Torrens</b>	
Dwelling—'The Oaks' .....	Corner Henley Beach and Tapleys Hill Roads, Fulham 5024. CT. volume 1672 folio 56, portion of section 194, hundred of Adelaide.

Dated at Adelaide, 8 November 1984.

D. J. HOPGOOD, Minister for Environment and Planning