

District Council of  
**RIDLEY**

**HERITAGE SURVEY OF THE**  
**RIVER MURRAY**



DEPARTMENT OF ENVIRONMENT AND PLANNING

HERITAGE INVESTIGATIONS

HERITAGE SURVEY OF THE MURRAY RIVER

(REGION 5 - SOUTH AUSTRALIA)

PART TWO

11. D.C. RIDLEY

ITEM IDENTIFICATION SHEETS

LIBRARY  
TRANSPORT SA  
PO BOX 1  
WALKERVILLE  
SA 5081

Prepared for the Heritage Conservation Branch of the Department of Environment and Planning by John Dallwitz and Susan Marsden of Heritage Investigations, assisted by Peter Donovan of Donovan and Associates. Adelaide 1984.

Funded under the National Estate Financial Assistance Programme.

DISTRICT COUNCIL OF RIDLEY

SOUTH-WESTERN SECTION

ITEM NO.	ITEM	SOURCE	SUBJECT	PERIOD	CURRENT STATUS	RECOMMEND- ATION
1	Stone Retaining Wall	#	4.7	1853-80		A

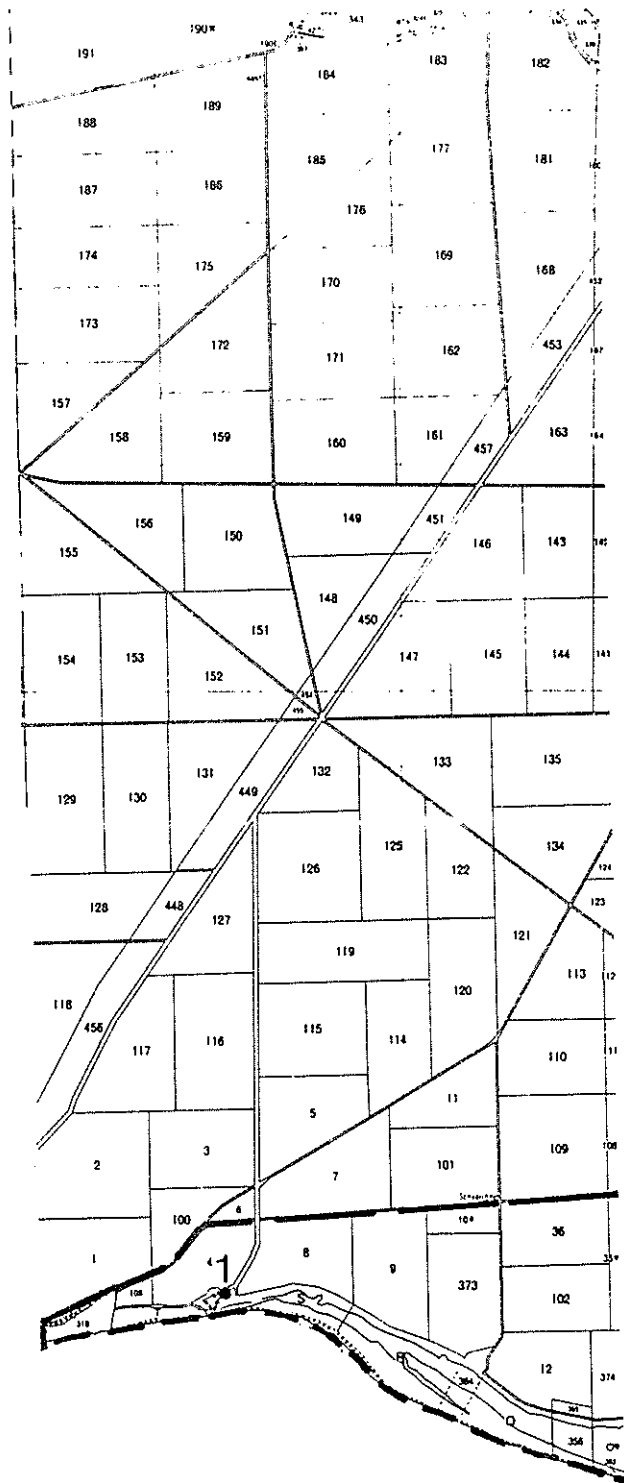

HERITAGE SURVEY REGION 5

— D.C. boundary

----- Region boundary

○ Refer to town map

● Item location

Scale 1:100,000

Heritage Investigations 1984

D.C. RIDLEY

SOUTH-WESTERN SECTION

DISTRICT COUNCIL OF RIDLEY

SOUTH-EASTERN SECTION

ITEM NO.	ITEM	SOURCE	SUBJECT	PERIOD	CURRENT STATUS	RECOMMENDATION
2	House (Groth)	CG	4.1	1853-80		B
3	House Ruin	CG	2.2	1853-80		B
4	Teal Flat Hut Ruin	CG	2.2	1853-80		B
5	Bow Hill Wharf	#	4.7	1906-40		B
6	Former Hall and Post Office	PD	2.6 4.8	1906-40		B
7	Cottage	PD	2.2	1881-1905		B
8	Cottage	PD	2.2	1881-1905		B
9	Former Post Office	PD	4.8	1881-1905		B
10	Cottage	PD	2.2	1881-1905		B
11	Gum Tree and Windmill Relics	#	1.5 4.9 4.10	1881-1905		A
12	Cutting	#	1.5 4.7	1881-1905		A
13	House	MF	2.2 4.10	1881-1905		B
14	St. Johns Lutheran Church	MF	2.5	1881-1905		B
15	Cottage	MF	2.2	1881-1905		B

CG : Colin Groth  
PD : Pad Dollard

MF : Murray Fromm

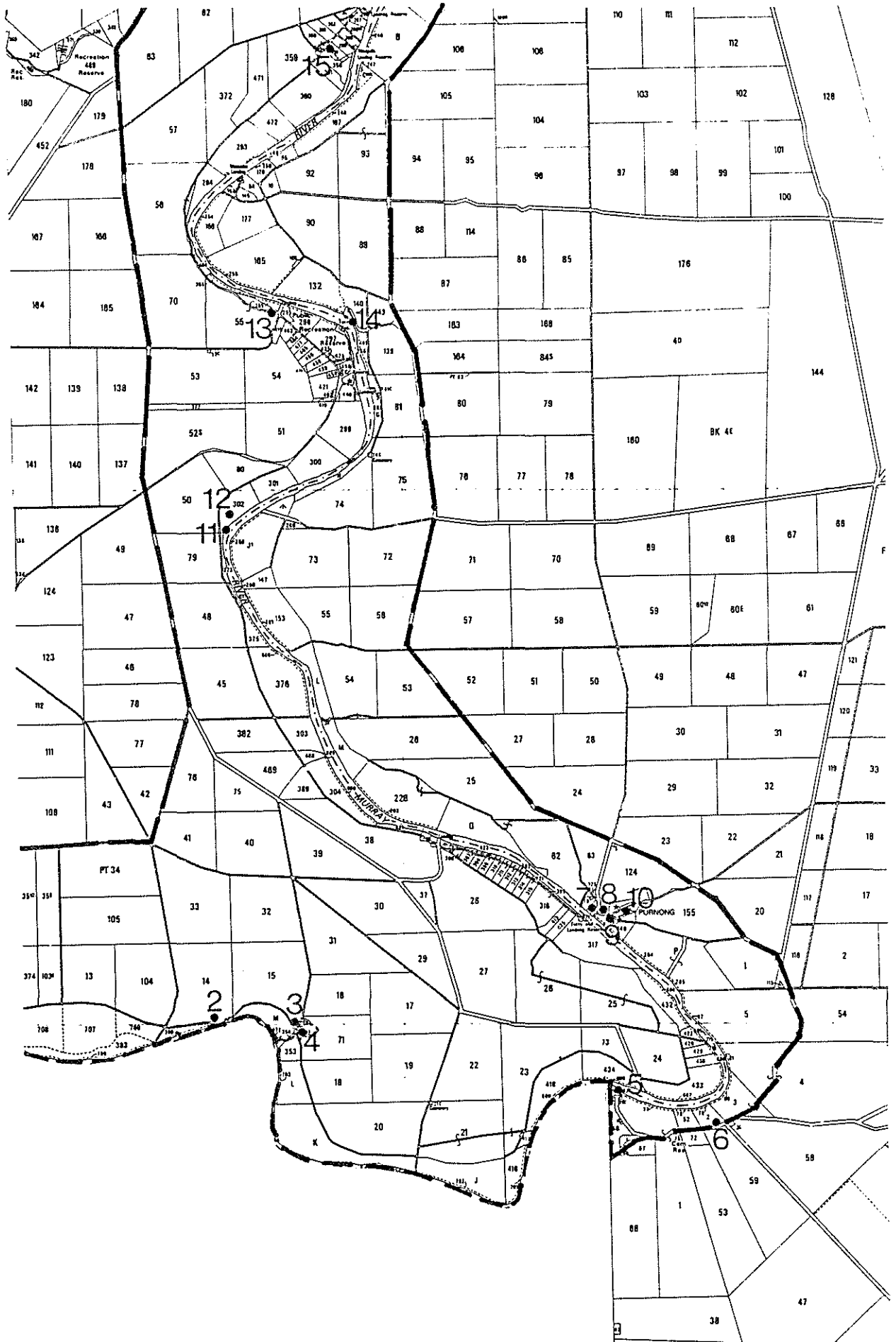

HERITAGE SURVEY REGION 5

- - - D.C. boundary      - - - Region boundary  
 ○ Refer to town map      ● Item location  
 Scale 1:100,000      Heritage Investigations 1984

D.C. RIDLEY  
 SOUTH-EASTERN SECTION

DISTRICT COUNCIL OF RIDLEY

NORTHERN SECTION

ITEM NO.	ITEM	SOURCE	SUBJECT	PERIOD	CURRENT STATUS	RECOMMENDATION
16	Former School	EN	2.6	1906-40		B
17	Shop and Post Office	EN	4.6 4.8	1906-40		B
18	"Sunnydale"	EN	4.1	1853-80		B
19	Punyelroo Cave	NFP	1.5			B
20	Cottage	EN	2.2	1881-1905		B
21	Swan Reach Public Hall	#	2.3	1906-40		A
22	Swan Reach Kindergarten	EN	2.6	1906-40		B
23	Zion Lutheran Church and Manse	EN	2.5	1906-40		B
24	House and Post Office	EN	2.2 4.8			B
25	Shop Complex (Swan Reach Bakery)	EN	4.6			B

EN : Ed Noack

NFP : Ngaiawang Folk Province

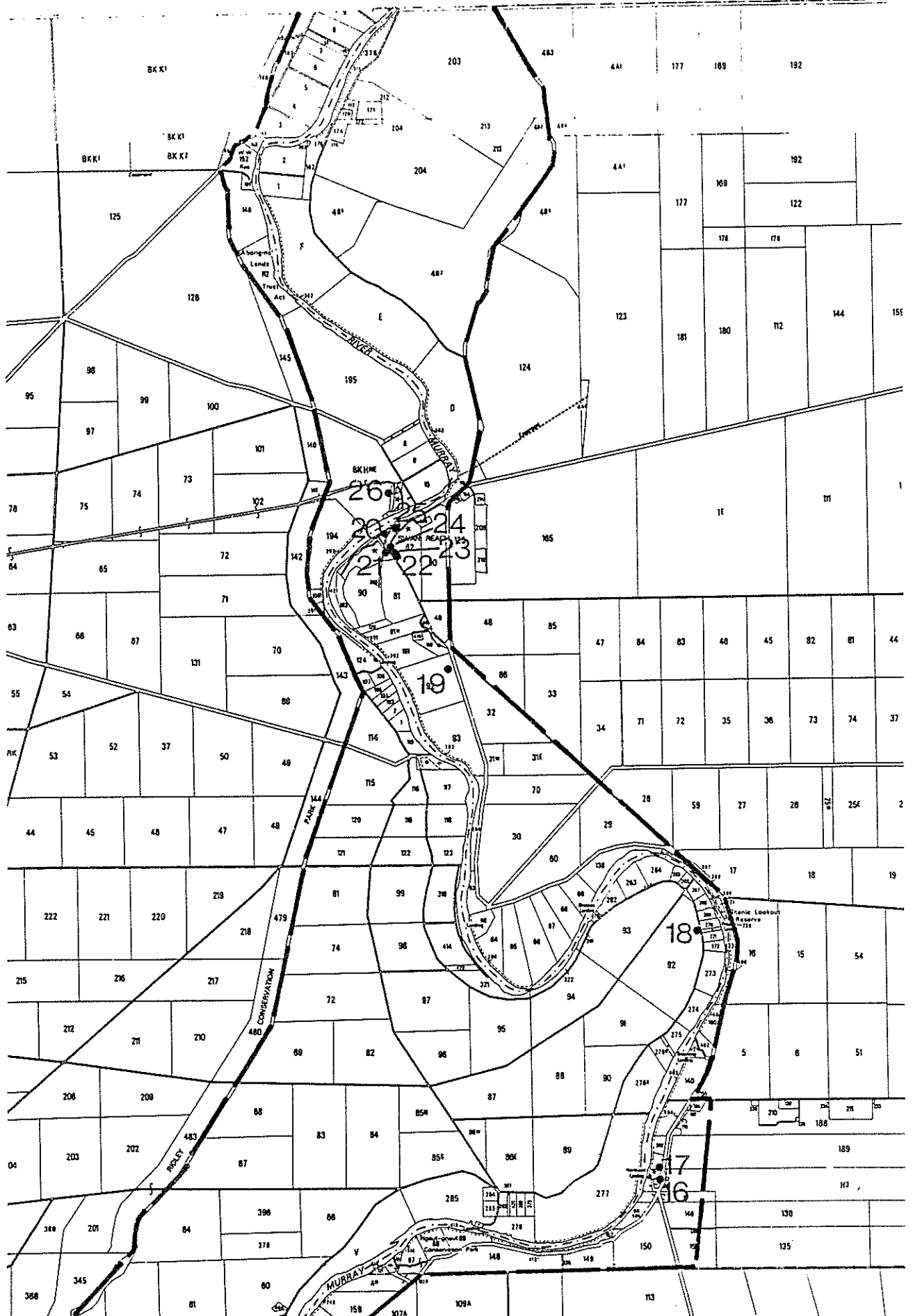

HERITAGE SURVEY REGION 5

- - - D.C. boundary      - - - Region boundary  
 ○ Refer to town map      ● Item location  
 Scale 1:100,000      Heritage Investigations 1984

D.C. RIDLEY  
NORTHERN SECTION



South  
Australian  
Heritage  
Act  
1978-80

# HERITAGE SURVEY ITEM IDENTIFICATION SHEET

HERITAGE SURVEY REGION 5

Item Ref. No. 1

ITEM NAME: Stone Retaining Wall  
Former or other

Office Use  
ITEM No.  
DOCKET No.

## HERITAGE SIGNIFICANCE

In the riverlands region there are few relics of early roads or retaining walls: this is, therefore, of significance because of its scarcity and its undoubted links with the earliest European use of the river.

The location was known as "stone wall" on early riverboat charts, which is now known as Rocky Point. The roadway, for which the retaining wall was built, leads to the old landing at Rocky Point.

LOCATION  
Address Rocky Point  
Town  
Postcode  
Section  
Hundred Ridley  
County  
L.G.A. Ridley  
S.H.P. Region 5  
A.M.G. Ref. 6728-II  
54 35750 614190

## SUBJECT

4.7

## PERIOD

State

Study Area  
1853-1880

## REFERENCES

Baker-Reschke Murray River Pilot, Goolwa to Renmark, p.20

Verbal Pat Dollard, 1983  
Archival photographs

## TYPE OF ITEM

LAND Natural feature   
Historical site   
Historical Gdn.   
BUILDING   
STRUCTURE   
PHYSICAL CONDITION

PHOTOGRAPH Film No. 813 Negative No. 15  
Direction of view to SW



## STATUS

Reg. of State Her. Items  
Reg.  Interim L.   
Nominated   
National Estate  
Reg.  Proposed L.   
National Trust  
CL  RL  File   
Other

## RECOMMENDATION

(A) State  (B) Local

PREPARED BY

HERITAGE INVESTIGATIONS

Date: 1983

IIS/D4/25.11.81

South  
Australian  
Heritage  
Act  
1978-80

# HERITAGE SURVEY ITEM IDENTIFICATION SHEET

PROJECT  
HERITAGE SURVEY REGION 5

Item Ref. No. 11

ITEM NAME: Gum Tree and Windmill Relics  
Former or other

Office Use  
ITEM No.  
DOCKET No.

## HERITAGE SIGNIFICANCE

This item at Fromm's Landing represents an unusual use of the native river red gum. Footholds have been cut into the tree and scaffolding at the top supported a windmill, which was used by the local landowner, J. McCullam, in the 1890s. This attempt to draw water from the river to his farm on the clifftop above was unsuccessful due to the lack of sufficient wind and the windmill pump was soon replaced by a motor.

## LOCATION

Address Fromms Landing

Town

Postcode

Section 302

Hundred Ridley

County

L.G.A. Ridley

S.H.P. Region 5

A.M.G. Ref. 6828-III

54 36670 614920

## SUBJECT

1.5

4.9

4.10

## PERIOD

State

Study Area

1881-1905

## REFERENCES

Verbal Murray Fromm, 1983  
Archival photographs

## TYPE OF ITEM

LAND Natural feature   
Historical site   
Historical Gdn.

BUILDING

STRUCTURE

PHYSICAL CONDITION

PHOTOGRAPH Film No. 813 Negative No. 3  
Direction of view to NW

## STATUS

Reg. of State Her. Items

Reg.  Interim L.

Nominated

National Estate

Reg.  Proposed L.

National Trust

CL  RL  File

Other

## RECOMMENDATION

(A) State  (B) Local

PREPARED BY

HERITAGE INVESTIGATIONS

Date: 1983



IIS/D4/25.11.81

South  
Australian  
Heritage  
Act  
1978-80

# HERITAGE SURVEY ITEM IDENTIFICATION SHEET

HERITAGE SURVEY REGION 5  
Item Ref. No. 12

ITEM NAME: Cutting  
Former or other

Office Use  
ITEM No.  
DOCKET No.

### HERITAGE SIGNIFICANCE

This impressive cutting was hand cut through the limestone cliff at Fromm's Landing to allow stock access to the river. It was made by a local farmer, J. McCullam, in about 1890 and continued in use by the Fromm family after their purchase of the property in 1902.

Water erosion of the pathway and retaining walls has prohibited its use recently.

### LOCATION

Address Fromms  
Town Landing  
Postcode  
Section 302  
Hundred Ridley  
County  
L.G.A. Ridley  
S.H.P. Region 5  
A.M.G. Ref. 6828-III  
54 36670 614960

### SUBJECT

1.5  
4.7

### PERIOD

State  
  
Study Area  
1881-1905

LIBRARY  
TRANSPORT SA  
PO BOX 1  
WALKERVILLE  
SA 5081

### REFERENCES

Verbal Murray Fromm, 1983  
Archival photographs

### TYPE OF ITEM

LAND Natural feature   
Historical site   
Historical Gdn.   
BUILDING   
STRUCTURE   
PHYSICAL CONDITION

PHOTOGRAPH Film No. 813 Negative No. 4  
Direction of view to N

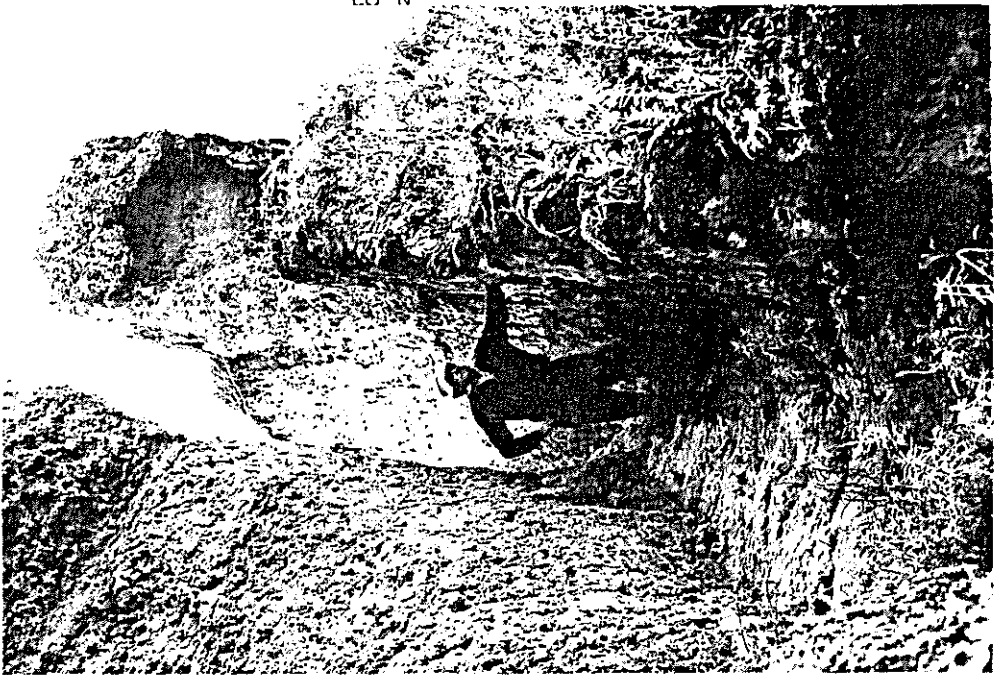

### STATUS

Reg. of State Her. Items  
Reg.  Interim L   
Nominated   
National Estate  
Reg.  Proposed L   
National Trust  
CL  RL  File   
Other

### RECOMMENDATION

(A) State  (B) Local

PREPARED BY  
HERITAGE INVESTIGATIONS

Date: 1983

IIS/D4/25.11.81

South  
Australian  
Heritage  
Act  
1978-80

# HERITAGE SURVEY ITEM IDENTIFICATION SHEET

PROJECT  
HERITAGE SURVEY REGION 5  
Item Ref. No. 21

ITEM NAME: Swan Reach Public Hall  
Former or other

Office Use  
ITEM No.  
DOCKET No.

### HERITAGE SIGNIFICANCE

This is an unusually finely detailed example of the architecture and building construction of the 1930s, using a mellow, rough-dressed local freestone. It appears to be in an entirely original condition, with a concrete porch and mullioned windows consistent with the style of the times.

It is one of the best examples of a small twentieth century hall standing in the riverlands region.

The hall was built in 1932, its foundation stone being laid also in that year by F.A. Nagel.

LIBRARY  
TRANSPORT SA  
PO BOX 1  
WALKERVILLE  
SA 5081

### LOCATION

Address

Town Swan Reach  
Postcode  
Section  
Hundred Nildottie  
County  
L.G.A. Ridley  
S.H.P. Region 5  
A.M.G. Ref. 6828-IV  
54 37110 617360

### SUBJECT

2.3

### PERIOD

State

Study Area

1906-40

### REFERENCES

Verbal Ed Noack, 1983  
Archival photographs

### TYPE OF ITEM

LAND Natural feature   
Historical site   
Historical Gdn.   
BUILDING   
STRUCTURE   
PHYSICAL CONDITION

PHOTOGRAPH Film No. 840 Negative No. 11  
Direction of view to SW



### STATUS

Reg. of State Her. Items  
Reg.  Interim L   
Nominated   
National Estate  
Reg.  Proposed L   
National Trust  
CL  RL  File   
Other

### RECOMMENDATION

(A) State  (B) Local

PREPARED BY

HERITAGE INVESTIGATIONS

Date: 1983