

**District Council of
COONALPYN DOWNS**

HERITAGE SURVEY OF THE SOUTH EAST



DEPARTMENT OF ENVIRONMENT AND PLANNING

DANVERS ARCHITECTS

HERITAGE SURVEY OF THE SOUTH EAST

(REGION 6 - SOUTH AUSTRALIA)

PART TWO

2. D.C. COONALPYN DOWNS

ITEM IDENTIFICATION SHEET

Prepared for the Heritage Conservation Branch of the Department
of Environment and Planning by Danvers Architects, Adelaide 1984.

DISTRICT COUNCIL OF COONALPYN DOWNS

ITEM NO.	ITEM	SOURCE	SUBJECT	PERIOD	CURRENT STATUS	RECOMMEND- ATION
1	Shearers' Quarters &. Shearing Shed, "Cold and Wet"	#	4.01		NT	A
2	Shearing Shed, "Tintinara"	#	4.01	1860-1880	SHR NE,NT	A*
3	Shearers' Quarters, "Tintinara"	#	4.01		SHR, NE,NT	A*
4	Shearers' Hut, "Tintinara"	#	4.01		SHR, NE,NT	A*
5	Northcott's Homestead	#	4.01	1900-1915		B
6	C.W.A. Building	#	2.05	1900-1915		B
7	Granite Underground Tank & Guttering System	#	4.09			A
8	William Harding Grave, "Tininara"	#	2.01	1860-1880		B
9	Gold Route Cairn	#	1.03			A
10	Homestead, "Coonalpyn"	#	4.01	1860-1880		B
11	Ruined Cottage	#	4.01			B
12	Large Soak	#	4.09			B
13	Water Storage System	#	4.09			A
14	Soak	#	4.09			B
15	Ruined Chimney	#	4.01			B
16	Railway Dam, "Strawbridge Park"	#	4.09			B

* Nos. 2-4 to be considered collectively.

DISTRICT COUNCIL OF COONALPYN DOWNS

ITEM NO.	ITEM	SOURCE	SUBJECT	PERIOD	CURRENT STATUS	RECOMMENDATION
17	Cottage, "Strawbridge Park"	#	4.09			B
18	Kitchen, "Strawbridge Park"	#	4.01			B
19	School, "Strawbridge Park"	#	4.01			B
20	Rocky Outcrop	#	1.06			B
21	Coonalpyn Church	#	2.05	1927		B
22	House	#	2.07			B
23	Homestead, "Old Bunbury"	#	4.01	1860-1880		B
24	Outbuilding, "Old Bunbury"	#	4.01			B
25	Shearing Shed, "Old Bunbury"	#	4.01			B
26	The Gold Route	#	1.02	1850-1860		A
27	Reedy Wells	#	4.09			A
28	Limestone Well	#	4.09			A
29	Mount Boothby Conservation Park	#	1.05			A
30	Pt. of Mount Rescue Conservation Park	#	1.05			A
31	Messent Conservation Park	#	1.05			A
32	Pt. of Martin's Washpool Conservation Park	#	1.05			A
33	Pt. of Kelvin Powrie Conservation Park	#	1.05			A

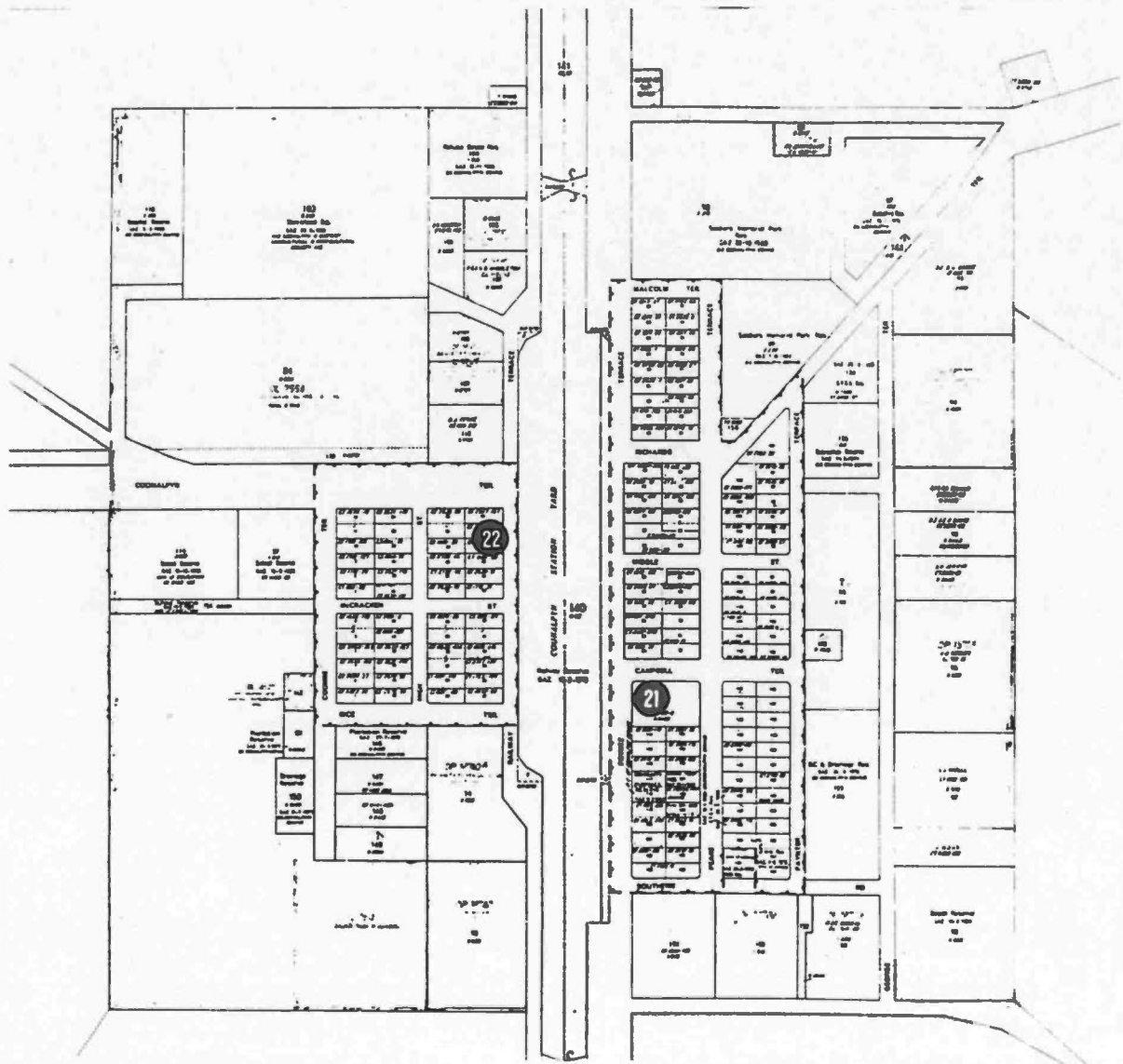

COONALPYN

LOCATION OF HERITAGE ITEMS AND AREAS

DEPARTMENT OF ENVIRONMENT AND PLANNING

HERITAGE CONSERVATION BRANCH

REGION 6 HERITAGE SURVEY

Darvers Architects 1983

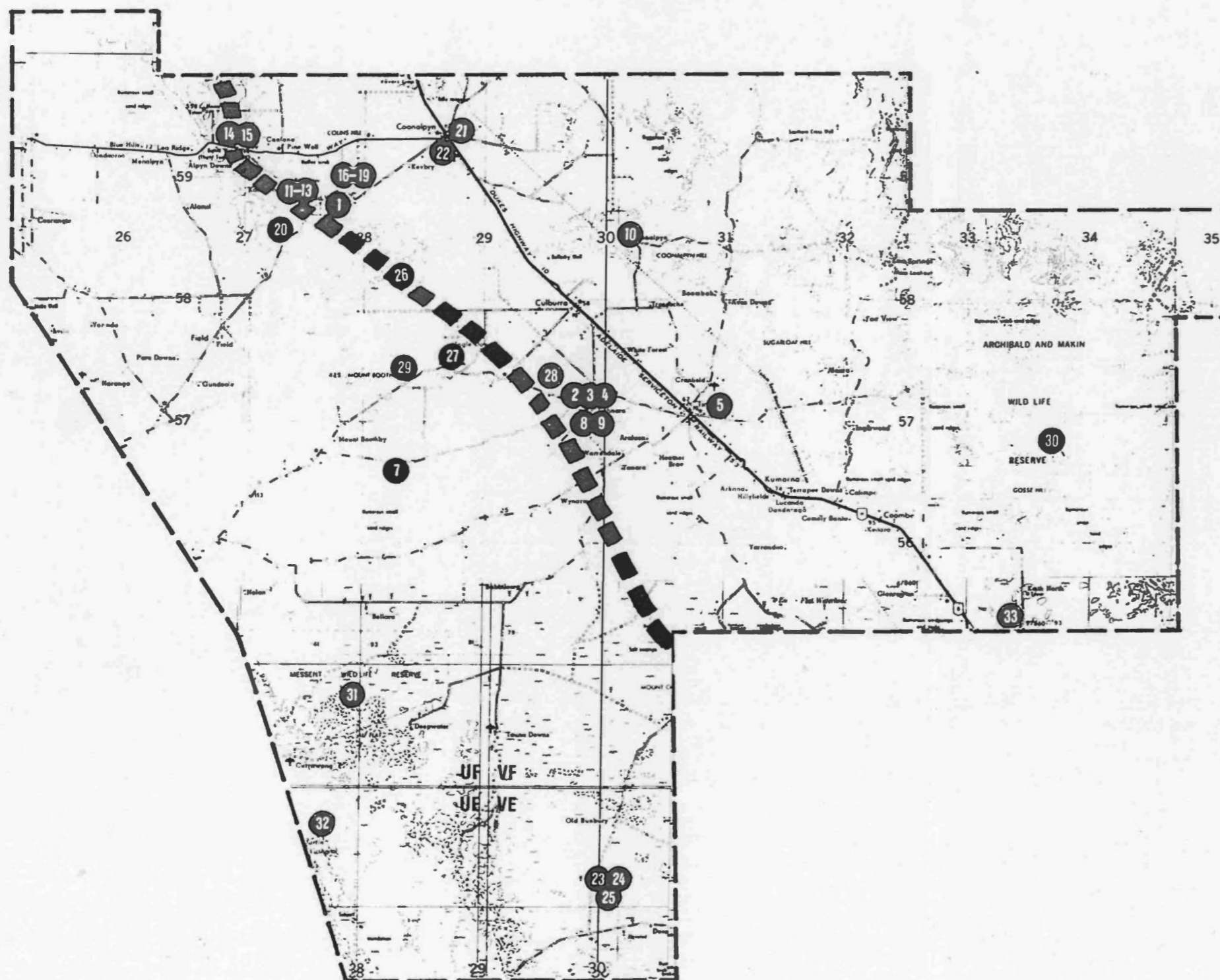

COONALPYN DOWNS LGA
 LOCATION OF HERITAGE ITEMS AND AREAS
 DEPARTMENT OF ENVIRONMENT AND PLANNING
 HERITAGE CONSERVATION BRANCH
 REGION 6 HERITAGE SURVEY
 Danvers Architects 1983
 Scale 0 5 10 15 20

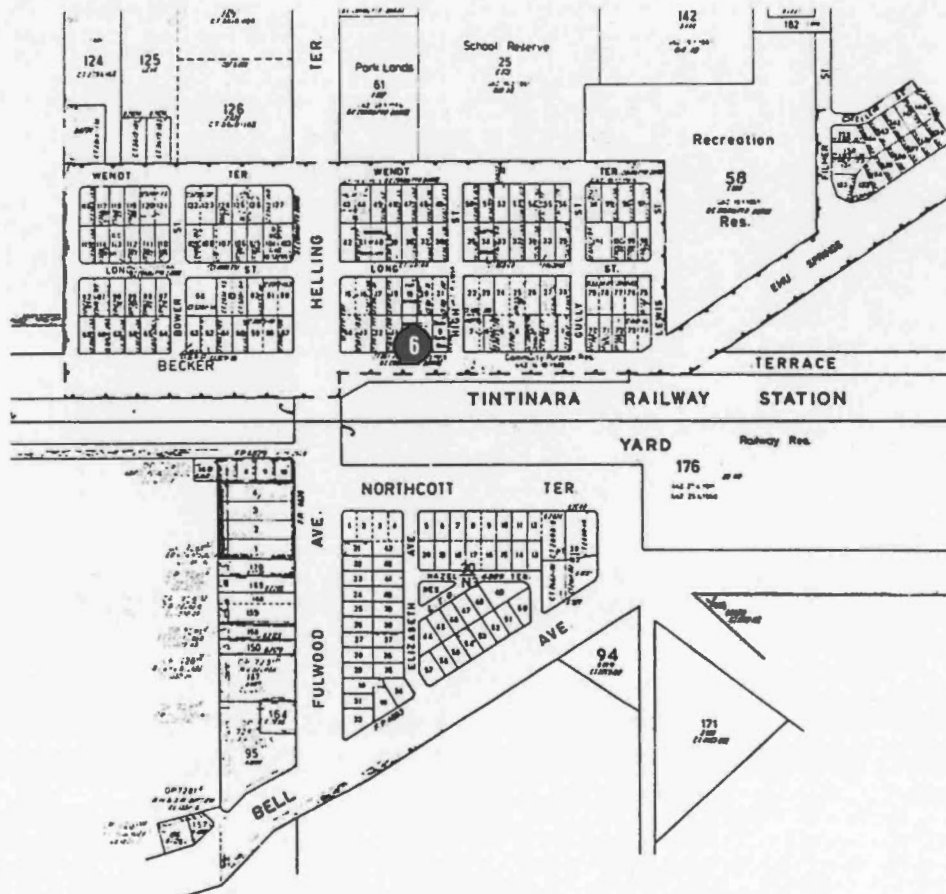

TINTINARA

LOCATION OF HERITAGE ITEMS AND AREAS

DEPARTMENT OF ENVIRONMENT AND PLANNING

HERITAGE CONSERVATION BRANCH

REGION 6 HERITAGE SURVEY

Danvers Architects 1983

Item No. : CDD:001

ITEM NAME: Shearers' Quarters & Shearing Shed, "Cold and Wet"

Former or other names: "Cold and Wet and Hungry" ?

LOCATION:

Address: Coonalpyn-Field Road,
near Coonalpyn

Allotment:

Section :

Hundred : Strawbridge

County : Cardwell

L.G.A. : Coonalpyn Downs

S.H.P. Region: 6

A.M.G., Ref. Z: 54 N: 6044500

E: 387750

TYPE OF ITEM:

Description: Shearing Shed

Subject: 4.01

Period:

Date:

Condition: Dilapidated

Architect:

Builder:

STATUS State Heritage List:

National Estate :

National Trust : Filed

HERITAGE SIGNIFICANCE

RECOMMENDATION: State

Description:

The structures are connected. An old stone sheepyard wall leads to the partly demolished shearing shed, connected to the Shearers' Quarters. Of faced sandstone construction, limewashed, some granite lintels over sub-floor vent openings. Imported milled timber in roof trusses. Windows Quarters six paned with ledged doors and hipped iron roof. Quarters of Georgian proportions and in fairly original condition.

'Henry Scott went into a large pastoral venture in the Ninety Mile Desert in partnership with Douglas Gooch, his brother-in-law. Their wool shed was at Cold and Wet. The experiences here were found to be quite different from those associated with the industry in the far north. They were indeed bitter experiences in this southern country, and after several years Henry Scott gave up the Cold and Wet venture after losing many thousands of pounds in the business, which was a veritable cold and wet experience financially' (R. Cockburn). Henry Scott had a distinguished career in South Australian pastoralism and politics.

Report Text:

REFERENCES: R. Cockburn, "Pastoral Pioneers" Vol. I pp. 194, 195

Verbal: Nigel Brookman
Judy Woolston
Michel Angas

PHOTOGRAPHS:

Slide No :

Film No : 10

Negative No: 26, 27, 28

Archival No:

DANVERS ARCHITECTS Date: 1983



Item No. : C00:002
ITEM NAME: Shearing Shed, "Tintinara"
Former or other names:

LOCATION:

Address: Tintinara-Woods Well
Road, near Tintinara

Allotment:

Section : 301

Hundred : Richards

County : Cardwell

L.G.A. : Coonalpyn Downs

S.H.P. Region: 6

A.M.G., Ref. Z: 54 N: 6028450
E: 407000

TYPE OF ITEM:

Description: Shearing Shed

Subject: 4.01

Period: 1860-1880

Date: 1860's

Condition: Fair

Architect:

Builder:

STATUS State Heritage List: Registered

National Estate : Listed

National Trust : Classified

HERITAGE SIGNIFICANCE

RECOMMENDATION: State

Description:

Random rubble stonework with corrugated galvanized iron hipped roof. 'T' shaped building with 16 stands along the head and lower wool room in the tail. Massive oregon roof framing with a 200 mm. x 200 mm. beam at T-junction. Roman numerals on roof framing to identify each element in relation to each other. Main joists are single lengths of oregon. Low stone dwarf walls in wool room (floor boards missing). Timber lintels to openings and timber fascia boards around building. Pen fittings and gratings are of sawn red gum.

The roof timbers carry the initials 'H & B', for Harding and Bunn, for whom the shearing shed was built. 'It is one of the best sheds in the South East' (R. Cockburn). The original owners of the station were T.W. and J.H. Boothby, but William Harding and George Bunn effected the major improvements. They at one time held hundreds of square miles of land and ran 40,000 sheep at "Tintinara". William Harding was buried near the shed in 1874.

Report Text:

REFERENCES: R. Cockburn, "Pastoral Pioneers" Vol. II p. 213
P. Twelftree, "History of Tintiara" pp. 4-8

Verbal: Pat Twelftree

PHOTOGRAPHS:

Slide No : 14/11

Film No : 15

Negative No: 2

Archival No:



Item No. : COO:003
ITEM NAME: Shearers' Quarters, "Tintinara"
Former or other names:

LOCATION:

Address: Tintinara-Woods Well
Road, near Tintinara

Allotment:

Section :

Hundred : Richards

County : Cardwell

L.G.A. : Coonalpyn Downs

S.H.P. Region: 6

A.M.G., Ref. Z: 54 N: 6028450
E: 407000

TYPE OF ITEM:

Description: Outbuilding

Subject: 4.01

Period:

Date:

Condition: Dilapidated

Architect:

Builder:

STATUS State Heritage List: Registered

National Estate : Listed

National Trust : Classified

HERITAGE SIGNIFICANCE

RECOMMENDATION: State

Description:

Random rubble stonework with corrugated galvanized iron gable ended roof (blown down). Large stone chimney and fireplace on the western end with arched iron Lintel and another chimney on the eastern end with a timber lintel above the fireplace. The building is divided into two areas - dining/living/sleeping area and kitchen.

Had been a dairy.

Refer to : COO:002:401.

Report Text:

REFERENCES: R. Cockburn, "Pastoral Pioneers" Vol. II p. 213
P. Twelftree, "History of Tintinara" pp. 4-6

Verbal: Pat Twelftree

PHOTOGRAPHS:

Slide No : 14/10

Film No : 15

Negative No: 1

Archival No:



Item No. : C00:004
ITEM NAME: Shearers' Hut, "Tintinara"
Former or other names:

LOCATION:

Address: Tintinara-Woods Well
Road, near Tintinara

Allotment:

Section :

Hundred : Richards

County : Cardwell

L.G.A. : Coonalpyn Downs

S.H.P. Region: 6

A.M.G., Ref. Z: 54 N: 6028500
E: 407300

TYPE OF ITEM:

Description: Outbuilding

Subject: 4.01

Period:

Date:

Condition: Fair

Architect:

Builder:

STATUS State Heritage List: Registered
National Estate : Listed
National Trust : Classified

HERITAGE SIGNIFICANCE

RECOMMENDATION: State

Description:

Random rubble stonework with corrugated galvanized iron gable ended roof. Timber lintels over door and small windows. Stone chimney with large timber lintel over fireplace (badly burnt). Rough plastered walls with newspaper cuttings pasted on to the interior walls of one room. Arched stonework lintel over southern door and large stone block quoins to doors and windows. Ceilings unlined.

Refer to : C00:002:401.

Report Text:

REFERENCES: R. Cockburn, "Pastoral Pioneers" Vol. II p. 213
P. Twelftree, "History of Tintinara" pp. 4-8

Verbal: Pat Twelftree

PHOTOGRAPHS:

Slide No : 14/10

Film No : 12

Negative No: 36

Archival No:



Item No. : C00:005
ITEM NAME: Northcott's Homestead
Former or other names:

LOCATION:
Address: S.E. of Tintinara

Allotment:
Section :
Hundred : Coombe
County : Cardwell
L.G.A. : Coonalpyn Downs
S.H.P. Region: 6
A.M.G., Ref. Z: 54 N: 6027300
E: 416300

TYPE OF ITEM:
Description: Homestead
Subject: 4.01
Period: 1900-1915
Date: 1907 Condition: Dilapidated
Architect:
Builder:

STATUS State Heritage List:
National Estate :
National Trust :

HERITAGE SIGNIFICANCE

RECOMMENDATION: Local

Description:

Rendered random rubble stonework with false coursing. Corrugated galvanized iron hipped roof with a bull nose verandah, which is supported by turned verandah posts and has the remnants of a low stone and concrete walls surrounding it. Windows were double hung sash with brick sills. Stone lean-to attached to rear of building with partially rendered brick flue. Several other corrugated galvanized iron lean-to additions and the remains of a baker's oven. Ruins of a random rubble outbuilding.

The Northcotts were a noted pioneering family in the time of smaller holdings.

Report Text:

REFERENCES: P. Twelftree, "History of Tintinara" p. 22

Verbal: Pat Twelftree

PHOTOGRAPHS:

Slide No : 14/6,7
Film No : 12
Negative No: 33 & 34

Archival No:



Item No. : C00:006
ITEM NAME: C.W.A. Building
Former or other names: Congregational Church

LOCATION:	TYPE OF ITEM:
Address: Becker Terrace, Tintinara	Description: Church
Allotment: 10	Subject: 4.01
Section :	Period: 1900-1915
Hundred : Coombe	Date: 1911 Condition: Well Kept
County : Cardwell	Architect:
L.G.A. : Coonalpyn Downs	Builder:
S.H.P. Region: 6	STATUS State Heritage List:
A.M.G., Ref. Z: 54 N: 6028400	National Estate :
E: 415750	National Trust :

HERITAGE SIGNIFICANCE

RECOMMENDATION: Local

Description:

Built in three sections with the porch and rear addition erected after the central part of the church. Random rubble stonework with brick quoins to the side windows and corners. Corrugated galvanized iron gable ended main roof with gable ended porch. Double hung sash arched windows with brick sills and pointed arched window to the porch. The rear addition has double hung sash windows with concrete lintels. The front elevation and the porch are rendered and painted. Ventilator to roof space on front elevation.

Used as a school and church until 1930. Visited by Parkin Missioners until 1932. Sunday School hall added in 1949. Increasing congregation prompted a new church in 1960's. Original church taken over by C.W.A. in 1966.

Report Text:

REFERENCES: P. Twelftree, "History of Tintinara" pp. 25, 26, 31, 46

Verbal: Pat Twelftree

PHOTOGRAPHS:

Slide No : 14/8
Film No : 12
Negative No: 35

Archival No:

DANVERS ARCHITECTS Date: 1983



Item No. : COO:007

ITEM NAME: Granite Underground Tank and Guttering System

Former or other names:

LOCATION:

Address: Tintinara-Woods Well
Road

Allotment:

Section :

Hundred : Colebatch

County : Cardwell

L.G.A. : Coonalpyn Downs

S.H.P. Region: 6

A.M.G., Ref. Z: 54 N: 6024000

E: 389000

TYPE OF ITEM:

Description: Water Supply

Subject: 4.09

Period:

Date:

Condition: Dilapidated

Architect:

Builder:

STATUS State Heritage List:

National Estate :

National Trust :

HERITAGE SIGNIFICANCE

RECOMMENDATION: State

Description:

Random rubble granite underground tank with some remaining concrete render. Approximately 5.00 metres square by 2.50 metres deep. Granite guttering around base of large granite outcrop drains into tank. The tank and guttering can no longer hold water.

Report Text:

REFERENCES:

Verbal: Pat Twelftree

PHOTOGRAPHS:

Slide No : 14/14, 15

Film No : 15

Negative No: 5 & 6

Archival No:



South Australian
Heritage Act 1978-80:

REGION 6 :
SOUTH EAST

Item No. : COO:008

ITEM NAME: William Harding Grave, "Tintinara"

Former or other names:

LOCATION:

Address: Tintinara-Woods Well
Road, near Tintinara

Allotment:

Section :

Hundred : Richards

County : Cardwell

L.G.A. : Coonalpyn Downs

S.H.P. Region: 6

A.M.G., Ref. Z: 54 N: 6028400

E: 407150

TYPE OF ITEM:

Description: Grave

Subject: 2.01

Period: 1860-1880

Date: 1874

Condition: Well Kept

Architect:

Builder:

STATUS State Heritage List:

National Estate :

National Trust :

HERITAGE SIGNIFICANCE

RECOMMENDATION: Local

Description:

William Harding, of Harding and Bunn, was buried July 1874 near the "Tintinara" shearing shed, and near the row of Tasmanian Blue Gums he had planted the year before. Grave originally enclosed by a wall.

Report Text:

REFERENCES: P. Twelftree, "History of Tintinara" pp. 6, 8

Verbal: Pat Twelftree

PHOTOGRAPHS:

Slide No : 14/12

Film No : 15

Negative No: 3

Archival No:

DANVERS ARCHITECTS Date: 1983



Item No. : C00:009

ITEM NAME: Cairn, marking route of the Gold Escort
Former or other names:

LOCATION:

Address: Tintinara-Woods Well
Road, near Tintinara

Allotment:

Section :

Hundred : Richards

County : Cardwell

L.G.A. : Coonalpyn Downs

S.H.P. Region: 6

A.M.G., Ref. Z: 54 N: 6028500
E: 407500

TYPE OF ITEM:

Description: Cairn

Subject: 1.03

Period:

Date:

Condition:

Architect:

Builder:

STATUS State Heritage List:

National Estate :

National Trust :

HERITAGE SIGNIFICANCE

RECOMMENDATION: State

Description:

Report Text:

REFERENCES:

Verbal: Pat Twelftree

PHOTOGRAPHS:

Slide No : 14/13

Film No : 15

Negative No: 4

Archival No:

DANVERS ARCHITECTS Date: 1983



Item No. : COO:010

ITEM NAME: Homestead, "Coonalpyn" Station

Former or other names:

LOCATION:

Address: N.E. of Culburra

Allotment:

Section :

Hundred : Lewis

County : Cardwell

L.G.A. : Coonalpyn Downs

S.H.P. Region: 6

A.M.G., Ref. Z: 54 N: 6041150

E: 410250

TYPE OF ITEM:

Description: Homestead

Subject: 4.01

Period: 1860-1880

Date: 1865 -

Condition: Fair

Architect:

Builder:

STATUS State Heritage List:

National Estate :

National Trust :

HERITAGE SIGNIFICANCE

RECOMMENDATION: Local

Description:

Random coursed stonework with Mount Gambier limestone quoins, string courses and bow fronted central section. Rock faced plinth/foundation. Corrugated galvanized iron gable ended roof with large gable over bow front. Left hand wing (west) rendered with cement slurry. The rear section, where the kitchen is now situated, was built first and the front section was added at a later date. The house was designed to have an outside door to every room. The front elevation has lead-light windows and the central bow front has a double door with semicircular fanlight. Stone tank is situated near the rear of the building.

The land was at various times leased by the Cooke Bros., Bunn and George Ormerod. A small homestead was built in 1865. There were two major additions, one dated 1902.

Report Text:

REFERENCES: R. Cockburn, "Pastoral Pioneers" Vol. I p. 149

Verbal: Jackie Cunningham
Pat Twelftree

PHOTOGRAPHS:

Slide No : 14/16

Film No : 15

Negative No: 7

Archival No:



South Australian
Heritage Act 1978-80:

REGION 6 :
SOUTH EAST

Item No. : C00:011
ITEM NAME: Ruined Cottage
Former or other names:

LOCATION:

Address: Kangaroo Flat, off
Coonalpyn-Meningie Rd.

Allotment:

Section :

Hundred : Strawbridge

County : Cardwell

L.G.A. : Coonalpyn Downs

S.H.P. Region: 6

A.M.G., Ref. Z: 54 N: 6044900

E: 384250

TYPE OF ITEM:

Description: Cottage

Subject: 4.01

Period: 1860-1880

Date:

Condition: Ruins

Architect:

Builder:

STATUS State Heritage List:

National Estate :

National Trust :

HERITAGE SIGNIFICANCE

RECOMMENDATION: Local

Description:

An unusual structure built against a large granite outcrop. Lower walls, including fireplace, cills and lintels, built of random granite to a height of about 2.00 metres. Walls raised in sandstone above. No roof remaining, but evidence of flashing to granite. Occupied supposedly by a Chinese man who was said to have built the soak, channel and well and the ingenious reservoir in the granite outcrop, seperately listed. Unsafe structure.

Report Text:

REFERENCES:

Verbal: Nigel Brookman
Judy Woolston
Michel Angas

PHOTOGRAPHS:

Slide No :

Film No : 10

Negative No: 33,34

Archival No:

DANVERS ARCHITECTS Date: 1983



Item No. : COO:012
ITEM NAME: Large Soak
Former or other names:

LOCATION:

Address: Kangaroo Flat, off
Coonalpyn-Meningie Rd.

Allotment:

Section :

Hundred : Strawbridge

County : Cardwell

L.G.A. : Coonalpyn Downs

S.H.P. Region: 6

A.M.G., Ref. Z: 54 N: 6044900
E: 385000

TYPE OF ITEM:

Description: Water Supply

Subject: 4.09

Period:

Date:

Condition:

Architect:

Builder:

STATUS State Heritage List:

National Estate :

National Trust :

HERITAGE SIGNIFICANCE

RECOMMENDATION: Local

Description:

Large soak in flat ground with stone lined channel leading to stone lined well, constructed to prevent fouling of soak. Near stone cottage. Used as water supply for vegetable garden by Chinese inhabitant of cottage.

Report Text:

REFERENCES:

Verbal: Nigel Brookman
Judy Woolston
Michel Angas

PHOTOGRAPHS:

Slide No :

Film No : 10

Negative No: 35

Archival No:



Item No. : COO:013
ITEM NAME: Water Storage System
Former or other names:

LOCATION:	TYPE OF ITEM:
Address: Kangaroo Flat, off Coonalpyn-Meningie Rd.	Description: Water Supply
Allotment:	Subject: 4.09
Section :	Period:
Hundred : Strawbridge	Date: Condition: Fair
County : Cardwell	Architect:
L.G.A. : Coonalpyn Downs	Builder:
S.H.P. Region: 6	STATUS State Heritage List:
A.M.G., Ref. Z: 54 N: 6044900	National Estate :
E: 385000	National Trust :

HERITAGE SIGNIFICANCE

RECOMMENDATION: State

Description:

An ingenious water storage system. Set on a ridge in a granite outcrop, partly dammed with shaped rocks and earth fill. Channels cut in granite draining to catchment. Behind and above ruined house.

Report Text:

REFERENCES:

Verbal: Nigel Brookman
Judy Woolston
Michel Angas

PHOTOGRAPHS:

Slide No :
Film No : 10
Negative No: 36

Archival No:



South Australian
Heritage Act 1978-80:

REGION 6 :
SOUTH EAST

Item No. : COO:014
ITEM NAME: Soak
Former or other names:

LOCATION:

Address: Kangaroo Flat, off
Coonalpyn-Meningie Rd.

Allotment:

Section :

Hundred : Strawbridge

County : Cardwell

L.G.A. : Coonalpyn Downs

S.H.P. Region: 6

A.M.G., Ref. Z: 54 N: 6044900

E: 385000

TYPE OF ITEM:

Description: Water Supply

Subject: 4.09

Period:

Date:

Condition:

Architect:

Builder:

STATUS State Heritage List:

National Estate :

National Trust :

HERITAGE SIGNIFICANCE

RECOMMENDATION: Local

Description:

Near ruined staging post on gold route, in area of native scrub.

Report Text:

REFERENCES:

Verbal: Nigel Brookman
Judy Woolston
Michel Angas

PHOTOGRAPHS:

Slide No :

Film No : 10

Negative No: 37

Archival No:



Item No. : C00:015
ITEM NAME: Ruined Chimney
Former or other names:

LOCATION:

Address: Binnie Well,
Coonalpyn-Meningie Rd.

Allotment:

Section :

Hundred : Strawbridge

County : Cardwell

L.G.A. : Coonalpyn Downs

S.H.P. Region: 6

A.M.G., Ref. Z: 54 N: 6047850
E: 381150

TYPE OF ITEM:

Description: Staging Post

Subject: 4.09

Period:

Date:

Condition: Ruins

Architect:

Builder:

STATUS State Heritage List:

National Estate :

National Trust :

HERITAGE SIGNIFICANCE

RECOMMENDATION: Local

Description:

Only remains of a Staging Post on the gold route. Sited on elevated ground overlooking gold route, surrounded by native scrub. A sandstone chimney.

Report Text:

REFERENCES:

Verbal: Nigel Brookman
Judy Woolston
Michel Angas

PHOTOGRAPHS:

Slide No :

Film No : 10

Negative No: 38

Archival No:



South Australian
Heritage Act 1978-80:

REGION 6 :
SOUTH EAST

Item No. : COO:016

ITEM NAME: Railway Dam, "Strawbridge Park"

Former or other names:

LOCATION:

Address: off Connalpyn-Field
Road, via Coonalpyn

Allotment:

Section :

Hundred : Strawbridge

County : Cardwell

L.G.A. : Coonalpyn Downs

S.H.P. Region: 6

A.M.G., Ref. Z: 54 N: 6044500

E: 387750

TYPE OF ITEM:

Description: Water Supply

Subject: 4.09

Period:

Date:

Condition:

Architect:

Builder:

STATUS State Heritage List:

National Estate :

National Trust :

HERITAGE SIGNIFICANCE

RECOMMENDATION: Local

Description:

Dam constructed c.1880 by massive excavation, about 10.00 metres deep, with channels cut to catchment. A failure - failed to hold water. Concrete spillway in good condition. Constructed to supply water to railways.

Report Text:

REFERENCES:

Verbal: Nigel Brookman
Judy Woolston
Michel Angas

PHOTOGRAPHS:

Slide No :

Film No : 10

Negative No: 29

Archival No:



Item No. : COO:017

ITEM NAME: Cottage, "Strawbridge Park"

Former or other names: Overseer's Cottage

LOCATION:

Address: off Coonalpyn-Field
Road, via Coonalpyn

Allotment:

Section :

Hundred : Strawbridge

County : Cardwell

L.G.A. : Coonalpyn Downs

S.H.P. Region: 6

A.M.G., Ref. Z: 54 N: 6044500

E: 387750

TYPE OF ITEM:

Description: Cottage

Subject: 4.09

Period:

Date:

Condition: Fair

Architect:

Builder:

STATUS State Heritage List:

National Estate :

National Trust :

HERITAGE SIGNIFICANCE

RECOMMENDATION: Local

Description:

Sandstone cottage with later enclosed verandahs and ruin at rear. Stone gables on simple ridged roof. Alterations and additions detract from originality and aesthetic qualities. Part of original "Cold and Wet".

Report Text:

REFERENCES:

Verbal: Nigel Brookman
Judy Woolston
Michel Angas

PHOTOGRAPHS:

Slide No :

Film No : 10

Negative No: 30

Archival No:



South Australian
Heritage Act 1978-80:

REGION 6 :
SOUTH EAST

Item No. : COO:018
ITEM NAME: Kitchen, "Strawbridge Park"
Former or other names:

LOCATION:

Address: off Coonalpyn-Field
Road, via Coonalpyn
Allotment:
Section :
Hundred : Strawbridge
County : Cardwell
L.G.A. : Coonalpyn Downs
S.H.P. Region: 6
A.M.G., Ref. Z: 54 N: 6044500
E: 387750

TYPE OF ITEM:

Description: Outbuilding
Subject: 4.01
Period:
Date: Condition: Dilapidated
Architect:
Builder:

STATUS State Heritage List:
National Estate :
National Trust :

HERITAGE SIGNIFICANCE

RECOMMENDATION: Local

Description:

Sandstone building with two large fireplaces and chimneys divided into Kitchen and Dining Room. Kitchen fireplace has smoking section. Has been used for general farming purposes and is partly demolished. Part of original "Cold and Wet". Many timber ruins around kitchen.

Report Text:

REFERENCES:

Verbal: Nigel Brookman
Judy Woolston
Michel Angas

PHOTOGRAPHS:

Slide No :
Film No : 10
Negative No: 31

Archival No:

DANVERS ARCHITECTS Date: 1983



South Australian
Heritage Act 1978-80:

REGION 6 :
SOUTH EAST

Item No. : CDO:019
ITEM NAME: School, "Strawbridge Park"
Former or other names:

LOCATION:

Address: off Coonalpyn-Field
Road, via Coonalpyn
Allotment:
Section :
Hundred : Strawbridge
County : Cardwell
L.G.A. : Coonalpyn Downs
S.H.P. Region: 6
A.M.G., Ref. Z: 54 N: 6044500
E: 387750

TYPE OF ITEM:

Description: School
Subject: 4.01
Period:
Date: Condition: Ruins
Architect:
Builder:

STATUS State Heritage List:
National Estate :
National Trust :

HERITAGE SIGNIFICANCE

RECOMMENDATION: Local

Description:

A small sandstone building with a chimney at one end, has been used for farming purposes and is partly demolished. Stone gable ends to simple ridged roof of sawn softwood, covered with iron. Part of original "Cold and Wet".

Report Text:

REFERENCES:

Verbal: Nigel Brookman
Judy Woolston
Michel Angas

PHOTOGRAPHS:

Slide No :
Film No : 10
Negative No: 32

Archival No:



South Australian
Heritage Act 1978-80:

REGION 6 :
SOUTH EAST

Item No. : COO:020
ITEM NAME: Rocky Outcrop
Former or other names:

LOCATION:

Address: Coonalpyn-Field Road,
via Coonalpyn

Allotment:

Section :

Hundred : Strawbridge

County : Cardwell

L.G.A. : Coonalpyn Downs

S.H.P. Region: 6

A.M.G., Ref. Z: 54 N: 6041500
E: 384300

TYPE OF ITEM:

Description: Natural Feature

Subject: 1.06

Period:

Date: Condition:

Architect:

Builder:

STATUS State Heritage List:

National Estate :

National Trust :

HERITAGE SIGNIFICANCE

RECOMMENDATION: Local

Description:

A scenic area of small hills with large granite boulder outcrops, particularly on summits with native scrub surrounding. Distant views over flat landscape contribute to the character of the area.

Report Text:

REFERENCES:

Verbal: Nigel Brookman
Judy Woolston
Michel Angas

PHOTOGRAPHS:

Slide No :

Film No : 10

Negative No: 24,25

Archival No:



Item No. : C00:021
ITEM NAME: Coonalpyn Church
Former or other names:

LOCATION:

Address: Poyntz Terrace,
Coonalpyn
Allotment:
Section :
Hundred : Coneybeer
County : Cardwell
L.G.A. : Coonalpyn Downs
S.H.P. Region: 6
A.M.G., Ref. Z: 54 N: 6049000
E: 396250

TYPE OF ITEM:

Description: Church
Subject: 2.05
Period: 1927
Date: 1927 Condition: Well Kept
Architect:
Builder:

STATUS State Heritage List:
National Estate :
National Trust :

HERITAGE SIGNIFICANCE

RECOMMENDATION: Local

Description:

Small gabled church of coursed rubble with brick quoins to corners, painted arch windows and flat arched doors. Smaller gabled vestry at rear with new raked verandah attached. Unusually roofed gabled lean-to entrance porch at front.

Report Text:

REFERENCES:

Verbal:

PHOTOGRAPHS:

Slide No :
Film No : 20
Negative No: 1,2

Archival No:



South Australian
Heritage Act 1978-80:

REGION 6 :
SOUTH EAST

Item No. : COO:022
ITEM NAME: House
Former or other names: Hall

LOCATION:
Address: Railway Terrace,
Coonalpyn
Allotment:
Section :
Hundred : Coneybeer
County : Cardwell
L.G.A. : Coonalpyn Downs
S.H.P. Region: 6
A.M.G., Ref. Z: 54 N: 6049000
E: 396500

TYPE OF ITEM:
Description: House
Subject: 2.07
Period:
Date: Condition: Dilapidated
Architect:
Builder:

STATUS State Heritage List:
National Estate :
National Trust :

HERITAGE SIGNIFICANCE

RECOMMENDATION: Local

Description:

Front wall of random coursed rubble with gabled parapet wall extending to protruding buttresses, reinforced with railway irons. Central door at front, pivoting and sash windows to side rubble walls, horizontal corrugated iron lean-to at rear. New raked corrugated iron verandah on tube steel (and some timber) posts.

Report Text:

REFERENCES:

Verbal:

PHOTOGRAPHS:

Slide No :
Film No : 20
Negative No: 3

Archival No:



South Australian
Heritage Act 1978-80:

REGION 6 :
SOUTH EAST

Item No. : CDO:023
ITEM NAME: Homestead, "Old Bunbury"
Former or other names:

LOCATION:
Address: West of Keith

Allotment:
Section :
Hundred : McNamara
County : Cardwell
L.G.A. : Coonalpyn Downs
S.H.P. Region: 6
A.M.G., Ref. Z: 54 N: 5997700
E: 409450

TYPE OF ITEM:
Description: Homestead
Subject: 4.01
Period: 1860-1880
Date: c.1869 Condition: Dilapidated
Architect:
Builder:

STATUS State Heritage List:
National Estate :
National Trust :

HERITAGE SIGNIFICANCE

RECOMMENDATION: Local

Description:

Random rubble stonework with massive stone chimney within wall structure. Asbestos cement addition to front corner. Corrugated galvanized iron gable ended roof extending into a raked front verandah with skillion roof at rear and attached porch. Timber lintels above openings. Small multi-paned casement windows with sidelights. Large sculptured fireplace in the corner of kitchen (blocked in). Verandah had floor of large stone slabs.

J.W.D. Denning took up a lease of 50 square miles in 1869-70, and he is said to have built the "Bunbury" homestead. It passed to J.R. Hutchison in the 1890's, Hensleys in the 1900's, Moseleys in the 1920's and so on.

Report Text:

REFERENCES: D. Fry, "Story of Keith" p. 67

Verbal: Gwen Ellis
Edith O'Brien

PHOTOGRAPHS:
Slide No : 12/87
Film No : 17
Negative No: 5

Archival No:

DANVERS ARCHITECTS Date: 1983



South Australian
Heritage Act 1978-80:

REGION 6 :
SOUTH EAST

Item No. : COO:024
ITEM NAME: Outbuilding, "Old Bunbury"
Former or other names:

LOCATION:

Address: West of Keith

Allotment:

Section :
Hundred : McNamara
County : Cardwell
L.G.A. : Coonalpyn Downs

S.H.P. Region: 6

A.M.G., Ref. Z: 54 N: 5997700
E: 409450

TYPE OF ITEM:

Description: Outbuilding

Subject: 4.01

Period:

Date:

Condition: Dilapidated

Architect:

Builder:

STATUS State Heritage List:

National Estate :

National Trust :

HERITAGE SIGNIFICANCE

RECOMMENDATION: Local

Description:

Random rubble stonework with corrugated galvanized iron gable ended roof and large stone chimney at one end. Timber lintels over openings. asbestos cement lined internal walls. East wall of building clad in corrugated galvanized iron. Cement rendered 'repairs' to lower sections some walls. Multi-paned casement windows.

Refer to : COO:023:401.

Report Text:

REFERENCES: D. Fry, "Story of Keith" p. 67

Verbal: Gwen Ellis
Edith O'Brien

PHOTOGRAPHS:

Slide No : 12/88

Film No : 17

Negative No: 6

Archival No:

DANVERS ARCHITECTS Date: 1983



South Australian
Heritage Act 1978-80:

REGION 6 :
SOUTH EAST

Item No. : COO:025
ITEM NAME: Shearing Shed, "Old Bunbury"
Former or other names:

LOCATION:
Address: West of Keith

Allotment:
Section :
Hundred : McNamara
County : Cardwell
L.G.A. : Coonalpyn Downs

S.H.P. Region: 6
A.M.G., Ref. Z: 54 N: 5997300
E: 409450

TYPE OF ITEM:

Description: Shearing
Subject: 4.01
Period:
Date:
Architect:
Builder:

Condition: Dilapidated

STATUS State Heritage List:
National Estate :
National Trust :

HERITAGE SIGNIFICANCE

RECOMMENDATION: Local

Description:

Random rubble limestone 'T'-shaped building with high rough stone plinth. Corrugated galvanized iron roof with flat gable at end of the tail of 'T' and raked roof over the head. Massive timber lintel over opening at end of gable and smaller timber lintels over other openings.

Refer to COO:023:401.

Report Text:

REFERENCES: D. Fry, "Story of Keith" p. 67

Verbal: Gwen Ellis
Edith O'Brien

PHOTOGRAPHS:

Slide No : 12/89
Film No : 17
Negative No: 7

Archival No:



Item No. : COO:026
ITEM NAME: The Gold Route
Former or other names:

LOCATION:

Address: Through the D.C. of
Coonalpyn Downs

Allotment:

Section :

Hundred :

County : Cardwell

L.G.A. : Coonalpyn Downs

S.H.P. Region: 6

A.M.G., Ref. Z: 54 N:
E:

TYPE OF ITEM:

Description: Gold Route

Subject: 1.02

Period: 1850-1860

Date: c.1852 Condition:

Architect:

Builder:

STATUS State Heritage List:

National Estate :

National Trust :

HERITAGE SIGNIFICANCE

RECOMMENDATION: State

Description:

The Gold Route in about 1852 followed a path from Wellington through
Pinkindoo Wells (Outside Region 6)
Hawks' Nest (Outside Region 6)
Binnies' Lookout (Coonalpyn Downs LGA)
Reedy Wells (Coonalpyn Downs LGA)
Limestone Well (Coonalpyn Downs LGA)
Two Wells (Tatiara LGA)
Binnies' Scrub Hut (Tatiara LGA)
Cannawigra Station (Tatiara LGA)
Scott's Woolshed (now Bordertown) (Tatiara LGA)

Report Text:

REFERENCES: D. Fry, "Story of Keith" p. 19

Verbal:

PHOTOGRAPHS:

Slide No :

Film No :

Negative No:

Archival No:

South Australian
Heritage Act 1978-80:

REGION 6 :
SOUTH EAST

Item No. : C00:027
ITEM NAME: Reedy Wells
Former or other names:

LOCATION:
Address: N.W. of "Tintinara"
Station
Allotment:
Section :
Hundred : Richards
County : Cardwell
L.G.A. : Coonalpyn Downs
S.H.P. Region: 6
A.M.G., Ref. Z: 54 N: 6013200
E: 397500

TYPE OF ITEM:
Description: Well
Subject: 4.09
Period:
Date: Condition:
Architect:
Builder:

STATUS State Heritage List:
National Estate :
National Trust :

HERITAGE SIGNIFICANCE

RECOMMENDATION: State

Description:
Part of the 1852 Gold Route.

Report Text:

REFERENCES:

Verbal:

PHOTOGRAPHS:
Slide No :
Film No :
Negative No:

Archival No:

South Australian
Heritage Act 1978-80:

REGION 6 :
SOUTH EAST

Item No. : C00:028

ITEM NAME: Limestone Well

Former or other names:

LOCATION:

Address: S.E. of "Tintinara"
Station

Allotment:

Section :

Hundred : Richards

County : Cardwell

L.G.A. : Coonalpyn Downs

S.H.P. Region: 6

A.M.G., Ref. Z: 54 N:
E:

TYPE OF ITEM:

Description: Well

Subject: 4.09

Period:

Date:

Condition:

Architect:

Builder:

STATUS State Heritage List:

National Estate :

National Trust :

HERITAGE SIGNIFICANCE

RECOMMENDATION: State

Description:

Part of the c.1852 Gold Route.

Report Text:

REFERENCES:

Verbal:

PHOTOGRAPHS:

Slide No :

Film No :

Negative No:

Archival No:

South Australian
Heritage Act 1978-80:

REGION 6 :
SOUTH EAST

Item No. : COO:029
ITEM NAME: Mount Boothby Conservation Park (C32)
Former or other names:

LOCATION:	TYPE OF ITEM:
Address: off Tintinara-Woods Well Road	Description: Conservation Park
Allotment:	Subject: 1.05
Section : 3	Period:
Hundred : Colebatch	Date: Condition:
County : Cardwell	Architect:
L.G.A. : Coonalpyn Downs	Builder:
S.H.P. Region: 6	STATUS State Heritage List:
A.M.G., Ref. Z: 54 N: 6033000	National Estate : Listed
E: 390000	National Trust :

HERITAGE SIGNIFICANCE

RECOMMENDATION: State

Description:
Approximate Area of Conservation Park - 4,045 hectares.
Date of Establishment - 1967.

Report Text:

REFERENCES: National Parks and Wildlife Act : Reserves - South Australia
Area Statement (As at June, 1982)

Verbal:

PHOTOGRAPHS:
Slide No :
Film No :
Negative No:

Archival No:

DANVERS ARCHITECTS Date: 1983

South Australian
Heritage Act 1978-80:

REGION 6 :
SOUTH EAST

Item No. : C00:030

ITEM NAME: Part of Mount Rescue Conservation Park (C11)

Former or other names:

LOCATION:

Address: Tintinara-Mount Rescue
Road

Allotment:

Section : 7-10

Hundred : Archibald

County : Cardwell

L.G.A. : Coonalpyn Downs

S.H.P. Region: 6

A.M.G., Ref. Z: 54 N: 6028000

E: 442000

TYPE OF ITEM:

Description: Conservation Park

Subject: 1.05

Period:

Date:

Condition:

Architect:

Builder:

STATUS State Heritage List:

National Estate : Listed

National Trust :

HERITAGE SIGNIFICANCE

RECOMMENDATION: State

Description:

Total Approximate Area of Conservation Park - 28,385 hectares.

Date of Establishment - 1953.

Report Text:

REFERENCES: National Parks and Wildlife Act : Reserves - South Australia
Area Statement (As at June, 1982)

Verbal:

PHOTOGRAPHS:

Slide No :

Film No :

Negative No:

Archival No:

South Australian
Heritage Act 1978-80:

REGION 6 :
SOUTH EAST

Item No. : C00:031

ITEM NAME: Messent Conservation Park (C19)

Former or other names:

LOCATION:

Address: off Tintinara-Woods
Well Road

Allotment:

Section : 1,10/1,65

Hundred : Messent/Colebatch

County : Cardwell

L.G.A. : Coonalpyn Downs

S.H.P. Region: 6

A.M.G., Ref. Z: 54 N: 6009000
E: 392000

TYPE OF ITEM:

Description: Conservation Park

Subject: 1.05

Period:

Date:

Condition:

Architect:

Builder:

STATUS State Heritage List:

National Estate : Listed

National Trust :

HERITAGE SIGNIFICANCE

RECOMMENDATION: State

Description:

Approximate Area of Conservation Park - 12,245 hectares.

Date of Establishment - 1964.

Report Text:

REFERENCES: National Parks and Wildlife Act : Reserves - South Australia
Area Statement (As at June, 1982)

Verbal:

PHOTOGRAPHS:

Slide No :

Film No :

Negative No:

Archival No:

South Australian
Heritage Act 1978-80:

REGION 6 :
SOUTH EAST

Item No. : C00:032

ITEM NAME: Part of the Martin's Washpool Conservation Park (C46)
Former or other names:

LOCATION:

Address: off Meningie-Kingston
S.E. Road

Allotment:

Section : 14

Hundred : Messent

County : Cardwell

L.G.A. : Coonalpyn Downs

S.H.P. Region: 6

A.M.G., Ref. Z: 54 N: 5997000
E: 385000

TYPE OF ITEM:

Description: Conservation Park

Subject: 1.05

Period:

Date:

Condition:

Architect:

Builder:

STATUS State Heritage List:

National Estate : Listed

National Trust :

HERITAGE SIGNIFICANCE

RECOMMENDATION: State

Description:

Total Approximate Area of Conservation Park - 564 hectares.

Date of Establishment - 1969.

Report Text:

REFERENCES: National Parks and Wildlife Act : Reserves - South Australia
Area Statement (As at June, 1982)

Verbal:

PHOTOGRAPHS:

Slide No :

Film No :

Negative No:

Archival No:

South Australian
Heritage Act 1978-80:

REGION 6 :
SOUTH EAST

Item No. : C00:033

ITEM NAME: Part of the Kelvin Powrie Conservation Park (C70)

Former or other names:

LOCATION:

Address: off Tintinara-Keith
Road

Allotment:

Section : 34

Hundred : Archibald

County : Cardwell

L.G.A. : Coonalpyn Downs

S.H.P. Region: 6

A.M.G., Ref. Z: 54 N: 6012000
E: 436000

TYPE OF ITEM:

Description: Conservation Park

Subject: 1.05

Period:

Date:

Condition:

Architect:

Builder:

STATUS State Heritage List:

National Estate : Listed

National Trust :

HERITAGE SIGNIFICANCE

RECOMMENDATION: State

Description:

Total Approximate Area of Conservation Park - 18 hectares.

Date of Establishment - 1971.

Report Text:

REFERENCES: National Parks and Wildlife Act : Reserves - South Australia
Area Statement (As at June, 1982)

Verbal:

PHOTOGRAPHS:

Slide No :

Film No :

Negative No:

Archival No: